

AKASO

# BRAVE 8 LITE

A C T I O N   C A M E R A



USER MANUAL

anba

# Content

Important Messages	06	>>
Micro SD Card Use	07	>>
IPX8 Waterproof Rating	08	>>
Overheating Detection	10	>>
1. Specifications	11	>>
2. What's in the Box	12	>>
3. Your Brave 8 Lite Action Camera	13	>>
4. First Use	15	>>
4.1 Unboxing	15	
4.2 Take the Camera out of the Camera Frame	15	
4.3 Detach the Camera Frame from the Packing Box	16	
4.4 Charge the Battery Separately	16	
4.5 Install the Battery	17	
4.6 Install the Micro SD Card	17	
4.7 Charge the Battery in the Camera	18	
4.8 Power on the Camera	18	
5. Getting Started	19	>>
5.1 Operation Instructions	19	>>
(1) Powering On and Off	19	
(2) Preview Screen	19	
(3) Using the Shutter Button	20	
(4) Quickly Switching Modes	20	
(5) Zooming in or out	22	
(6) Video Sound	22	
(7) Album Access	23	
(8) Setting Resolution	23	
(9) Image Stabilization	24	
(10) Switching Screens	24	

(11) Button Functions Overview	25	
<b>5.2 Quick Operation Guide</b>	<b>26</b>	<b>&gt;&gt;</b>
<b>5.3 Quick Menu</b>	<b>27</b>	<b>&gt;&gt;</b>
(1) Voice Control	28	
(2) Wifi	28	
(3) Screen Brightness	29	
(5) One Key Fast Shooting	29	
(6) Grid	30	
(7) Preferences	30	
(8) Exiting the Quick Menu	30	
<b>6. Video</b>	<b>31</b>	<b>&gt;&gt;</b>
<b>6.1 Video Modes</b>	<b>31</b>	<b>&gt;&gt;</b>
(1) Video Mode	33	
(2) Time Lapse Video Mode	34	
(3) Hyperlapse Mode	35	
(4) Slow Motion Mode	36	
(5) HDR Video Mode	37	
<b>6.2 Video Settings</b>	<b>38</b>	<b>&gt;&gt;</b>
(1) Video Resolution	40	
(2) Time Lapse Interval	41	
(3) Hyperlapse Speed	42	
(4) Slow Motion Speed	42	
(5) Image Stabilization	43	
(6) Metering	44	
(7) EV	45	
(8) ISO	45	
(9) White Balance	46	
(10) Sharpness	46	
(11) Bit Rate	47	
(12) Color	47	
(13) Fragment	47	
(14) Wind Noise Reduction	48	
(15) Distortion Calibration	48	

(16) HindSight	49	
6.3 Video Settings Menu	51	>>
6.4 Resolution Availability for Video Recording	52	>>
<b>7. Photo</b>	<b>54</b>	<b>&gt;&gt;</b>
7.1 Photo Modes	54	>>
(1) Photo Mode	56	
(2) Time Lapse Photo Mode	57	
7.2 Photo Settings	58	>>
(1) Photo Resolution	59	
(2) Metering	59	
(3) EV	60	
(4) ISO	61	
(5) Shutter	61	
(6) White Balance	61	
(7) Sharpness	62	
(8) Color	62	
(9) Distortion Calibration	63	
(10) Self-Timer	63	
(11) Image Format	63	
(12) Burst Photo	64	
7.3 Photo Settings Menu	65	>>
<b>8. System Settings</b>	<b>66</b>	<b>&gt;&gt;</b>
8.1 Preferences	66	>>
① Setting Preferences	66	
② Quick Settings Guidance	66	
(1) Voice Control	67	
(2) Language	67	
(3) Video Format	68	
(4) Code	68	
(5) Wireless Connection	68	
(6) Remote	70	
(7) One Key Fast Shooting	71	

(8) Gyroscope .....	71	
<b>8.2 General Settings .....</b>	<b>72</b>	<b>&gt;&gt;</b>
(1) Screen Brightness .....	72	
(2) Sound .....	73	
(3) Indicator Light .....	75	
(4) Video Sound .....	77	
(5) Auto Power Off .....	77	
(6) Screen Saver .....	78	
(7) Date & Time .....	78	
(8) Date Stamp .....	80	
(9) Format .....	80	
(10) Factory Reset .....	81	
(11) Voice Commands .....	82	
(12) About .....	82	
<b>9. Album .....</b>	<b>83</b>	<b>&gt;&gt;</b>
9.1 Album Access .....	83	>>
9.2 Album Screen .....	84	>>
9.3 Video Playback .....	84	>>
(1) Playback Videos .....	84	
(2) Video Screen .....	84	
9.4 Photo Playback .....	85	>>
(1) Playback Photos .....	85	
(2) Photo Screen .....	86	
9.5 File Deletion .....	86	>>
(1) Delete Files from the Album Screen .....	86	
(2) Delete Files on the Video Screen .....	87	
(3) Delete Files on the Photo Screen .....	87	
<b>10. Data Transmission .....</b>	<b>88</b>	<b>&gt;&gt;</b>
10.1 Transfer Files to a Computer .....	88	
10.2 Using the Brave 8 Lite as a Web Cam .....	89	
<b>11. App Download &amp; Wifi Connection .....</b>	<b>90</b>	<b>&gt;&gt;</b>
11.1 Camera Wifi .....	90	

11.2 Features of the AKASO GO App .....	90	>>
11.3 Download the AKASO GO App .....	91	>>
11.4 Create An Account for the AKASO GO App .....	91	>>
11.5 Connect to the AKASO GO App via Wifi .....	92	>>
11.6 AKASO GO App Menu .....	94	>>
(1) User Interface .....	94	
(2) Video .....	94	
(3) Photo .....	96	
(4) Album .....	99	
(5) System Settings .....	104	
(6) OTA Update .....	107	
<b>12. Remote .....</b>	<b>110</b>	<b>&gt;&gt;</b>
12.1 Connect to the Remote .....	110	
12.2 Button Operation Instructions .....	111	
<b>13. Mount Your Brave 8 Lite Action Camera .....</b>	<b>112</b>	<b>&gt;&gt;</b>
<b>14. Troubleshooting .....</b>	<b>113</b>	<b>&gt;&gt;</b>
<b>15. Battery Maintenance .....</b>	<b>114</b>	<b>&gt;&gt;</b>
15.1 Maximizing Battery Life .....	114	
15.2 Note .....	114	
15.3 Battery Handling and Storage .....	114	
<b>16. Precautions .....</b>	<b>115</b>	<b>&gt;&gt;</b>
<b>17. Contact Us .....</b>	<b>116</b>	<b>&gt;&gt;</b>

## Important Messages

Congratulations on your new AKASO Brave 8 Lite Action Camera! You must be excited to use your new camera, but please spend some time familiarizing yourself with this manual first so that you get the most out of your camera's features and use it safely.

1. It's important to regularly update the camera's firmware. Connect your camera to the AKASO GO app through the camera's Wifi to download and install the latest firmware.
2. This camera is a precision instrument. Safeguard it from drops or impacts to prevent damage.
3. Store the camera away from devices or objects with strong magnetic fields or power, like motors and magnets.
4. Ensure the camera operates within its recommended temperature range. Avoid leaving it at high or low temperatures for extended periods, as this can reduce its lifespan.
5. This camera body is waterproof, but make sure all covers are tightly closed and the lens area is free from debris before immersing it underwater.
6. After using the camera in saltwater, rinse it with fresh water and gently dry it with a soft cloth.
7. Don't charge the battery for a long period of time.
8. Keep the battery away from kids and pets to prevent accidents.
9. Remove the battery from the camera if you don't plan to use it for an extended period.
10. Store the camera away from sharp objects and moisture-prone areas.



## Micro SD Card Use

To capture photos and videos, you'll need a separate memory card. We recommend branded memory cards that meet the following criteria:

1. U3
2. Capacity up to 512GB (FAT32)

### Warm Tips:

1. Format the memory card in the camera before using it to ensure compatibility.
2. Memory cards larger than the specified maximum capacity can cause issues like non-recognition or even camera malfunctions like unresponsiveness or firmware failure.
3. Regularly reformat your memory card for optimal performance. Remember, reformatting erases all data, so transfer your photos and videos before re-formatting. With FAT32, the card will stop recording and create a new file if the filesize of a recording reaches 4GB.

### Notes:

1. Don't use the card near strong currents or magnetic fields.
2. Don't let the card touch metal objects, or use any metal tools on it in case it's squeezed, bent, or falls.
3. Store the card in dry places away from corrosive substances.
4. Insert the card into the card slot in the right orientation.
5. Ensure that no foreign items are inserted into the card slot.
6. Turn off the camera before inserting or removing the card.





## IPX8 Waterproof Rating

- ① The Brave 8 Lite action camera boasts an IPX8 waterproof rating, allowing submersion up to 10 meters (33 feet) deep without an external case. However, always ensure the protective covers are tightly sealed to prevent any leakage. Listen for a click - this means the covers are securely fastened and you can begin your underwater adventure with peace of mind.

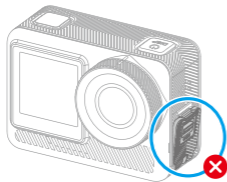

USB port cover not closed securely

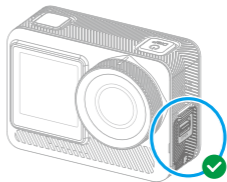

USB port cover closed securely

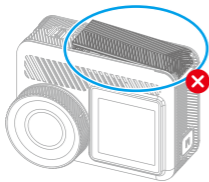

Battery cover not closed securely

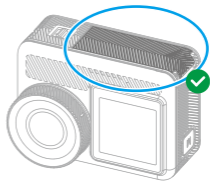

Battery cover closed securely



Lens cover not closed securely



Lens cover closed securely



- ② While the Brave 8 Lite action camera is waterproof, moisture can interfere with the touchscreen, resulting in screen drift or multiple screen jumps. Therefore, it's best to use the physical buttons for underwater operations.

For more on this, see the section: **Button Functions Overview**.

For instance, to switch shooting modes underwater, ensure the camera displays the preview screen and then press the Mode button. Pressing the Mode button again on the mode menu screen switches modes.

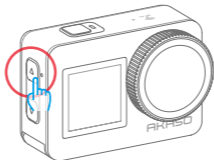

- ③ To prevent touchscreen issues underwater, lock the screen by tapping the Lock icon on the quick menu. Unlocking is just as simple: tap the Lock icon and swipe up.

**Reminder:** The camera cannot be operated through the touchscreen underwater; please use the buttons instead.

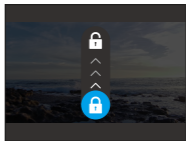
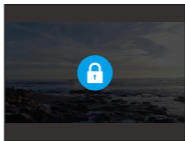
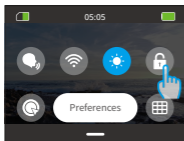

- ④ If you plan a deep dive, equip your Brave 8 Lite with the waterproof case (sold separately) to prevent it from getting soaked.

**Note:** The camera won't record sound when it's in the waterproof case.

## Overheating Detection

The Brave 8 Lite action camera is designed to detect overheating conditions thanks to its built-in thermistor sensor. Should the camera get too hot, a red **“Temperature too high! The camera will automatically shut down”** warning will display on the touchscreen, followed by an automatic shutdown. When this happens, allow the camera to cool down before using it again. This helps bump up performance by protecting the the camera's hardware from damage.

### Note:

1. The Brave 8 Lite action camera's optimal operating temperature range is between  $-5^{\circ}\text{C}$  und  $45^{\circ}\text{C}$  ( $23^{\circ}\text{F}$  und  $113^{\circ}\text{F}$ ). Using the camera in excessively high or low temperatures may impact its performance.
2. Capturing at a high resolution and frame rate can cause the camera to consume more power and heat up more quickly, especially in warmer environments. Consider using lower settings in such conditions to lower the risk of overheating your Brave 8 Lite.



# 1. Specifications

Brand	AKASO
Name	4K Versatile Brave 8 Lite Action Camera
Model	Brave 8 Lite
Size	66×44×34 mm
Net weight	112 g
Material	Plastic, silicone, glass
Battery capacity	1550 mAh
Battery life	90mins of recording time in 4K, and 150mins in 1080P. <b>Note:</b> The actual battery life may vary based on the environment and usage.
Wireless network	RF 2.4G+Wifi 2.4GHz
Camera Waterproof Rating	IPX8
Remote aterproof grade	IPX4
Operating Temperature	-5°C~45°C (23°F~113°F)
External Microphone	Supported but sold separately. <b>Note:</b> Be sure to purchase external microphones compatible with this camera.



## 2. What's in the Box



Brave 8 Lite  
x1



Camera Frame  
x1



Battery Charger  
x1



Battery  
x2



USB Cable  
x1



Remote Control  
x1



Bandage  
x1



Spanner  
x1



Helmet Mount 1  
x1



Helmet Mount 2  
x1



Buckle Mount  
x1



J-Hook Mount  
x1



E Mount  
x1



C Mount  
x1



D Mount  
x1



F Mount  
x1



A Mount  
x1



H Mount  
x1



Tether  
x5



Lens Cloth  
x1



Double-Sided  
Adhesive Tape x2



Quick Start  
Guide x1



### 3. Your Brave 8 Lite Action Camera

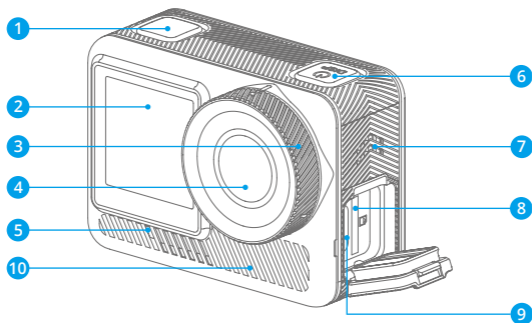

1 Shutter/Confirm Button

2 Front Screen

3 Lens Cover

4 Lens

5 Working Indicator

6 Power Button

7 Speaker

8 Micro SD Card Slot

9 USB / External Mic Port

10 Vents



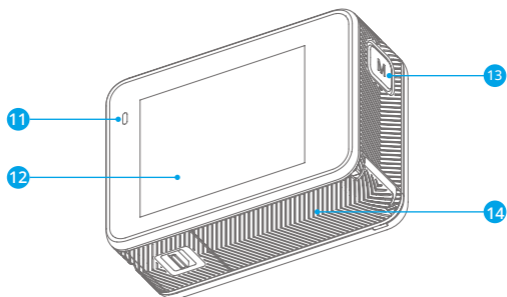

- 11 Charging Indicator
- 12 Touchscreen
- 13 Mode Button
- 14 Battery Cover

## 4. First Use

### 4.1 Unboxing

Open the packing box along the dotted line, then take out the Brave 8 Lite action camera and its accessories.



- 1 Open the packing box along the dotted line

- 2 Take out the action camera and its accessories

### 4.2 Take the Camera out of the Camera Frame

First, pull up the camera frame's buckle as indicated by the arrow to release the latch and open the door. Then, take the camera out of the camera frame.



- 1 Pull up the camera frame's buckle

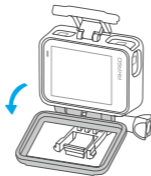

- 2 Open the camera frame's door

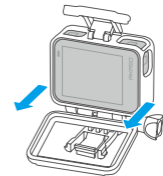

- 3 Take the camera out of the camera frame





### 4.3 Detach the Camera Frame from the Packing Box

First, turn the screw rod counterclockwise using your hand or the included spanner. After removing the rod, take the camera frame out of the box. Then, remove the silicon gel from the camera frame. Finally, lift the mount buckle and slide it back to release it from its position.

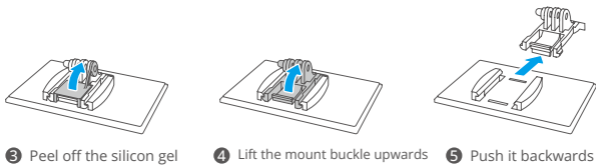
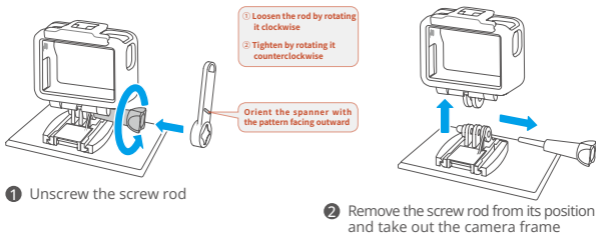

### 4.4 Charge the Battery Separately

Connect the battery charger to a USB outlet, then insert the battery.

**Note:** The battery charger indicator will appear red while charging and blue when fully charged.

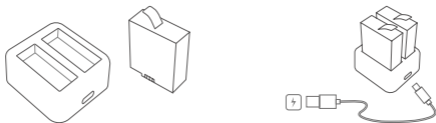

#### 4.5 Install the Battery

Press the buckle of the battery cover to open it, then place the battery into its slot and close the battery cover. To remove the battery, pull the battery strip.

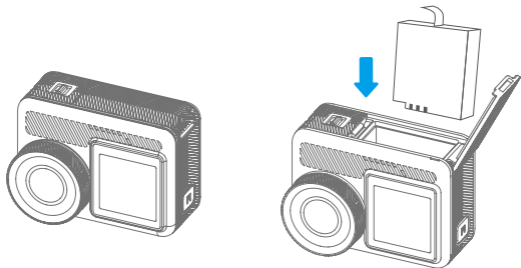

#### 4.6 Install the Micro SD Card

First press the charging cover to reveal the memory card slot, then insert the memory card in the orientation shown and close the cover.

**Note:** Be sure to turn off the camera before installation.

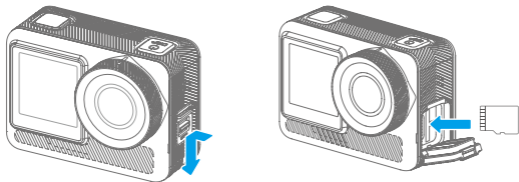

#### 4.7 Charge the Battery in the Camera

Connect the camera to a USB adapter or computer using the USB cable. Once fully charged, disconnect the cable and ensure the battery cover is securely fastened.

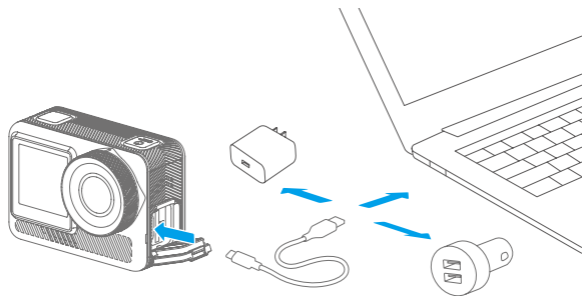

#### 4.8 Power on the Camera

Press and hold the Power button to turn on the Brave 8 Lite action camera. Ensure all the camera covers are securely closed before powering it on.

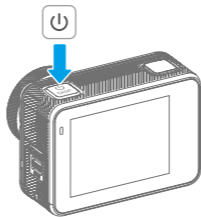

## 5. Getting Started

### 5.1 Operation Instructions

#### (1) Powering On and Off

**Powering On:** While the camera is off, press and hold the Power button to turn it on.

**Powering Off:** While the camera is on, press and hold the Power button to turn it off.

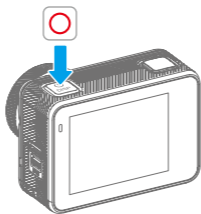

#### (2) Preview Screen



- |                           |                          |              |
|---------------------------|--------------------------|--------------|
| 1 SD Card Capacity        | 4 Audio Recording Status | 7 Zoom       |
| 2 Remaining Card Capacity | 5 Current Shooting Mode  | 8 Resolution |
| 3 Preview Screen          | 6 Battery Level          |              |



### (3) Using the Shutter Button

In Photo or Video mode, press the Shutter button to capture photos or start video recording. To stop recording in Video mode, press the Shutter button again.

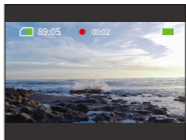
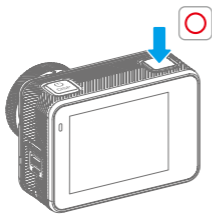

### (4) Quickly Switching Modes

There are 3 ways to switch modes.

**Method 1:** On the preview screen, tap the Mode icon to access the mode menu, choose "Video" or "Photo", and swipe left or right to select a desired shooting mode from the available options, then swipe up to return.

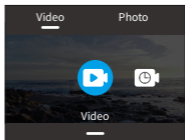

**Method 2:** On the preview screen, swipe right to access the mode menu, and swipe left or right to select a desired shooting mode from the available option, then swipe up to return.

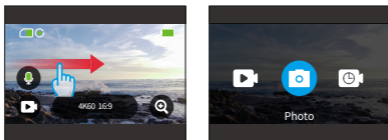

Method 3: On the preview screen, press the Mode button to access the mode menu, then press the Mode button again to toggle among the shooting modes.

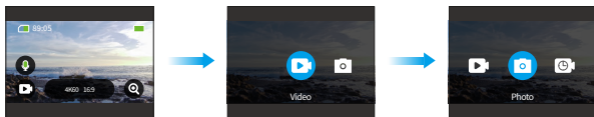
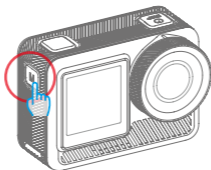

## (5) Zooming in or out

You can adjust viewing angles by tapping the “+” icon.

Options: Super Wide Angle / Wide Angle / Portrait Perspective / Narrow Angle.

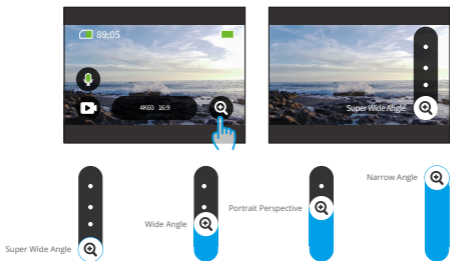

※ The zoom feature is unavailable in Hyperlapse mode or with Image Stabilization enabled.

## (6) Video Sound

Turn the video sound feature on or off. When disabled, the camera will record videos without audio.

On the preview, tap the microphone icon to turn the video sound feature on or off.

**Tip:** The microphone icon will turn green when Video Sound is enabled, and turn white when disabled; You can also turn this feature on or off by tapping the “Video Sound” option on the Universal screen.

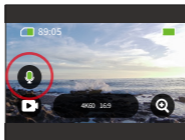

**Note:** The camera does not record sound when it's in the waterproof case.

## (7) Album Access

Swipe left from the preview screen to enter the playback screen, and tap the icon in the upper left corner to access the album.

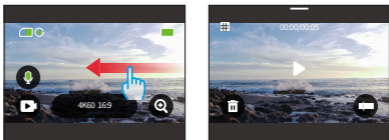

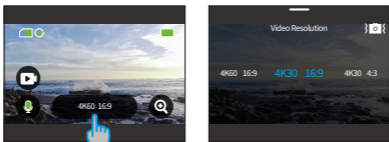

## (8) Setting Resolution

To configure resolution settings, tap the resolution icon at the bottom of to access the resolution settings screen, then swipe left or right to choose the desired resolution. After the configuration is complete, swipe down to exit.





## (9) Image Stabilization

You can also configure the image stabilization settings on the resolution settings screen. To select a desired image stabilization level, simply tap on its icon. Options include Turn off , Normal , and SuperSmooth .

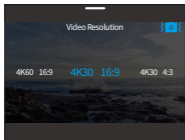

Normal Image Stabilization On

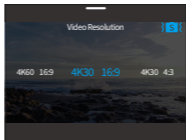

SuperSmooth On

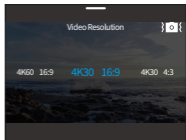
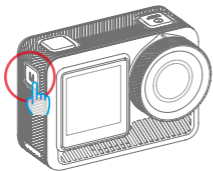

Image Stabilization Off

**Tip:** A blue icon means the selected stabilization is active, while a white one means it's inactive. To go back to the preview screen, simply swipe down.

## (10) Switching Screens

On the preview screen, press and hold the Mode button for 3 seconds to toggle between front and touch screens.



※ The touchscreen can't be operated when using the front screen.

## (11) Button Functions Overview

Refer to the below guide for button functions during various operations:

Camera Status	Buttons	Operations	Functions
Power-off	Power Button	Press and hold	Turn on the camera.
	Shutter Button	Short-press	With the One Key Fast Shooting feature enabled, the camera will automatically turn on and start recording as soon as you press this button. To stop recording and turn off the camera, simply press this button again.
Capturing	Power Button	Press and hold	Turn off the camera.
		Short-press	Turn the display on or off. ( <b>Tip:</b> The camera will keep recording even if the display is turned off. )
	Shutter Button	Short-press	When the camera is in Photo mode, press this button to take a photo. When the camera is in Video mode, press this button to start or stop recording.
	Mode Button	Press and hold	Switch between the front and touch screens.
		Short-press	Switch shooting modes.

## 5.2 Quick Operation Guide

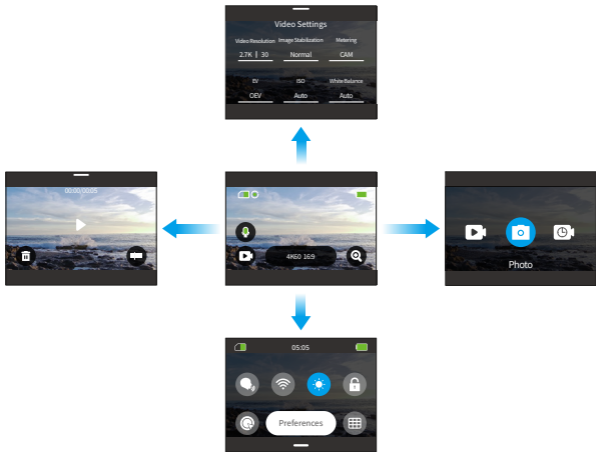

### 1. Swipe right to access the mode menu

On the preview screen, swipe right to enter the mode menu. Swipe left or right to select your desired shooting mode.

### 2. Swipe left to access the playback screen

Swipe left from the preview screen to enter the playback screen. Tap the Square icon in the upper left corner to enter the album screen.

### 3. Swipe up to access the Video / Photo Settings screen

Swipe up from the preview screen to enter the video or photo settings screen.

### 4. Swipe down to access the quick menu

Swipe down from the preview screen to open the quick menu.



## 5.3 Quick Menu

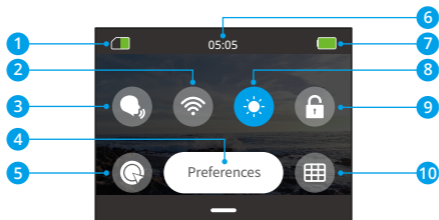

- |                              |                     |
|------------------------------|---------------------|
| 1 Remaining SD Card Capacity | 6 Time              |
| 2 Wifi                       | 7 Battery Level     |
| 3 Voice Control              | 8 Screen Brightness |
| 4 Preferences                | 9 Screen Lock       |
| 5 One Key Fast Shooting      | 10 Grid             |

You can access the quick menu by swiping down from the preview screen.

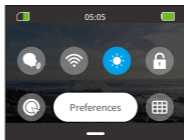
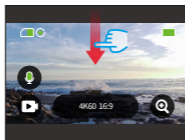

## (1) Voice Control

Voice Control offers hands-free operation using supported voice commands. With Voice Control enabled, you can issue any supported voice command to the camera. The camera will respond to the given voice commands and execute various functions. For a comprehensive list of voice commands, see the section **System settings**→**General Settings**→**Voice Command** or check it through **Preferences**→**General Settings**→**Voice Command** on the camera.

Tap the Voice Control icon on the quick menu to toggle this feature. A blue icon indicates it's active; a gray one means it's off.

**Tip:** You can also enable the voice control feature from the preferences screen.

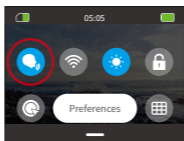

## (2) Wifi

The built-in Wifi connects the camera to the AKASO GO app, facilitating file downloads. More information can be found in the section: **App Download & Wifi Connection** → **Camera Wifi**.

To turn Wifi on or off, simply tap the Wifi icon. The Wifi icon turns blue when activated and gray when it's off.

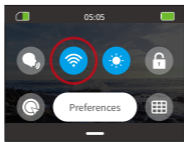

※ If the camera's Wifi is activated but not linked to the app within 3 minutes, it will auto-disable. Re-activate the camera's Wifi to reconnect to the app.

### (3) Screen Brightness

Modify screen brightness by tapping its icon on the quick menu. Brightness levels range from 50% to 100%.

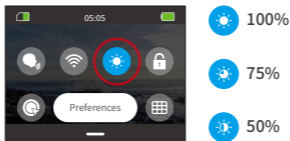

### (4) Screen Lock

This feature ensures the camera remains locked—ideal for underwater scenarios. Tap the Lock icon on the quick menu to engage this feature. To unlock, tap the Lock icon and swipe the slider upwards.

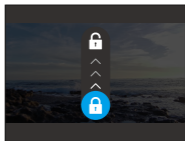
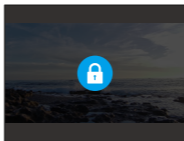
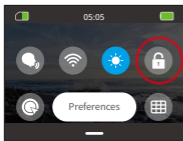

### (5) One Key Fast Shooting

When enabled, the camera will automatically turn on and start recording as soon as you press the Shutter button in the power-off state. To stop recording, simply press the Shutter button again. The camera will then save the video file and power off.

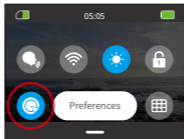

## (6) Grid

The grid feature can enhance video quality by helping you properly compose shots and select optimal viewing angles.

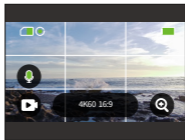
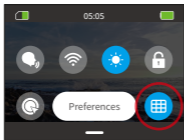

## (7) Preferences

Access the preferences settings screen by tapping the "Preferences" option on the quick menu.

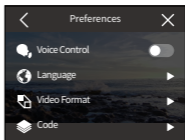
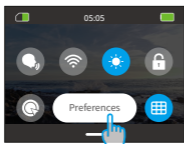

## (8) Exiting the Quick Menu

Swipe up from the quick menu to return to the preview screen.

## 6. Video

### 6.1 Video Modes

This camera boasts a variety of video modes: Video, Time Lapse, Hyperlapse, Slow Motion, and HDR.

- ① To choose a video mode, tap the Mode icon in the bottom left corner to enter the mode menu, then choose “Video”, and swipe left or right to navigate among the available options.

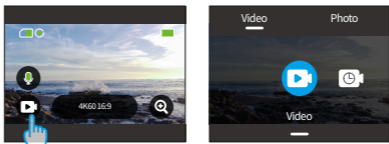

- ② Once you've selected your mode, either tap and swipe up at the screen's bottom to return to the preview screen or wait 5 seconds for the camera to automatically transition to the chosen mode.

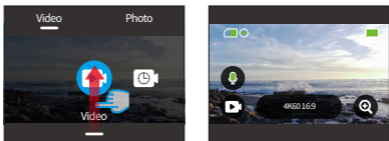



- ③ From the preview screen, tap the bottom of the screen and swipe up to access the video settings.



- ④ On the video settings screen, swipe up for additional settings. Different modes offer varied settings; for more details, refer to the section: **Video Settings Menu**.

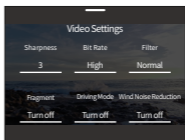
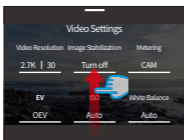

- ⑤ After completing the setup, swipe down to return to the preview screen.

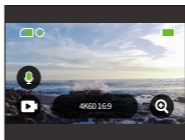
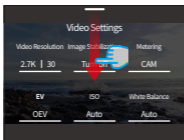

## (1) Video Mode

The camera is in Video mode by default when turned on. In this mode, press the Shutter button to record normal video at the preset resolution and frame rate.

- ① Choose “Video” to enter the default Video Mode.

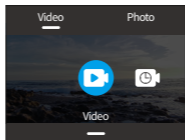

- ② Tap the “Resolution” icon to access the quick menu and adjust the following settings.

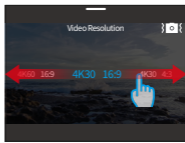

**\*Video Resolution:** Swipe left or right to select your preferred resolution.

**\*Image Stabilization:** Tap the image stabilization icon to configure this feature.

- ③ Swipe up to access additional settings for Resolution, Frame Rate, Image Stabilization, Color, and more (see **Video Settings Menu**). After completing the setup, tap the bottom of the screen and swipe up to return to Video mode.

## (2) Time Lapse Video Mode

Time Lapse Video Mode condenses longer events into brief clips by capturing frames at designated intervals. For example, recording a 20-minute span at a 2-second interval produces a 20-second fast-motion video, whereas a 10-second interval results in a 4-second fast-motion clip.

**Tip:** The video length varies based on the set interval.

① Choose "Time Lapse Video" to enter Time Lapse Video Mode.

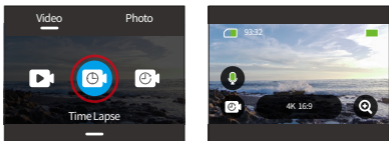

② Tap the "Resolution" icon to access the quick menu and tailor your desired settings for creating a captivating time lapse video.

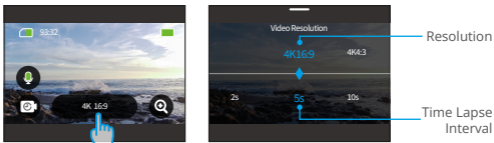

**\*Video Resolution:** Swipe left or right to select your preferred resolution.

**\*Time Lapse Interval:** Swipe left or right to select your preferred Time Lapse Interval.

③ Swipe up to access additional video settings for Resolution, Frame Rate, Time Lapse Interval, Color, and more (see **Video Settings Menu**). After completing the setup, tap the bottom of the screen and swipe up to return to Time Lapse Video Mode.

### (3) Hyperlapse Mode

The Hyperlapse Video mode enables the camera to produce steady and fluid fast-motion videos, seemingly faster than real-time. This mode is perfect for capturing dynamic scenes.

For instance, a 6-minute video captured at a 2X shutter speed results in a 3-minute fast-motion video, while using a 10X shutter speed gives a 36-second fast-motion video.

- ① Choose “Hyperlapse” to activate the Hyperlapse Mode.

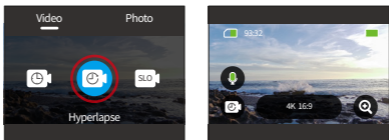

- ② Tap the “Resolution” icon to access the quick menu and adjust the following settings.

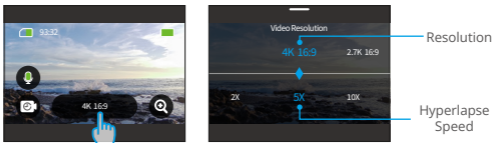

**\*Video Resolution:** Swipe left or right to select your preferred resolution.

**\*Hyperlapse Speed:** Swipe left or right to select your preferred speed.

- ③ Swipe up to access additional video settings for Resolution, Hyperlapse Speed, Color, and more (see **Video Settings Menu**). After completing the setup, tap the bottom of the screen and swipe up to return to Hyperlapse Video mode.

#### (4) Slow Motion Mode

The Slow Motion Mode allows the camera to capture footage at your chosen resolution and slow-motion rate, but it saves the video at a playback rate of 30 fps. This ensures that on playback, the video displays in a captivating slow-motion effect.

For instance, a 10-second clip shot at 720P 4X results in a 40-second video played at 720P30FPS. Essentially, the video is played four times slower, making this mode perfect for capturing fast-moving scenes.

- ① Choose "Slow Motion" to activate the Slow Motion Mode.

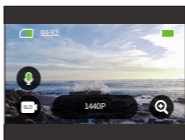
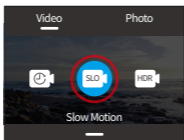

- ② Tap the "Resolution" icon to access the quick menu and adjust the following settings.

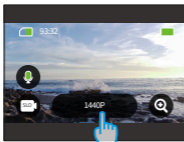

**\*Video Resolution:** Swipe left or right to select your preferred resolution.

**\*Slow Motion Speed:** Swipe left or right to select your preferred speed.

- ③ Swipe up to access additional video settings for Resolution, Slow Motion Speed, Color, and more (see **Video Settings Menu**). After completing the setup, tap the bottom of the screen and swipe up to return to Slow Motion Mode.

## (5) HDR Video Mode

HDR (High Dynamic Range) Video can bring out stunning detail and authentic color in both highlights and shadows, bringing your shots to life. HDR Video records up to 4K30 videos.

- ① Choose “HDR” to enter HDR Video Mode.

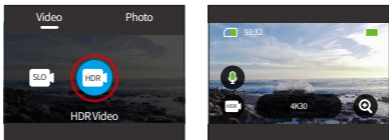

- ② Tap the “Resolution” icon to access the quick menu.

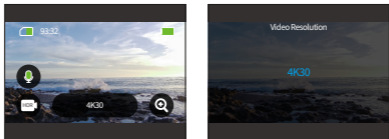

**Note:** In HDR Video mode, the only resolution option available is 4K30.

## 6.2 Video Settings

Customize your settings for an engaging video experience.

- ① In Video mode, swipe up to bring up the video settings screen.

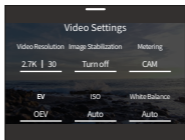

- ② Within the Video Settings, you can explore a wide range of configuration options by scrolling.

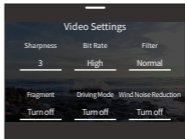
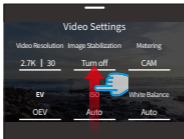

- ③ On each settings screen, swipe up or down to select a desired setting.

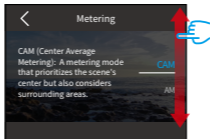

- ④ Once you've adjusted your settings, tap the "<" icon located at the top left to save your modifications and return to the Video Settings screen.

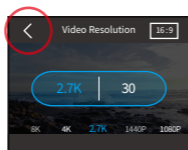

- ⑤ To go back to the preview screen, simply swipe down.

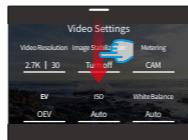



## (1) Video Resolution

The camera is capable of recording videos in resolutions up to 4K60FPS. While higher resolutions yield clearer and more detailed footage owing to the increased pixel count, they also produce larger file sizes.

- To adjust the resolution, first ensure the camera is set to Video mode. Then, swipe up to access the video settings interface. Select the "Video Resolution" option to enter the settings screen.



- Swipe left or right to choose from the available options.

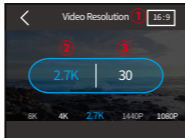

- Aspect ratio:** 16:9/4:3

The resolution options vary based on the selected aspect ratio.

16:9 aspect ratio: 4K/2.7K/1080P

4:3 aspect ratio: 4K/2.7K/1440P

- Resolution:** 4K/2.7K/1080P/1440P/720P

- Frame rate**

The frame rate options vary based on the selected video format.

- NTSC: 240/180/120/90/60/30

- PAL: 200/150/100/75/50/25

## (2) Time Lapse Interval

Set the interval at which the camera captures a scene in Time Lapse Video mode. The camera will capture scenes at the predefined interval and seamlessly compiles them into a video.

For instance, if the time lapse interval is set to "5s", the camera will record a scene every 5 seconds, converting longer footage into a short video. This mode is ideal for capturing mesmerizing transitions like sunrises, sunsets, blossoming flowers, and more.

- ① To adjust the Time Lapse Interval, first ensure the camera is in Time Lapse Video mode. Then tap the "Resolution" icon to access its settings.



- ② Select a desired time lapse interval from the available options.

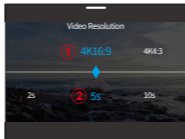

- ① **Resolution:** 4K/2.7K/1080P/1440P
- ② **Timelapse Interval:** 2s/5s (default)/10s/30s/1min/2min/5min/10min/30min/1h
- ※ This feature is only available in Time Lapse Video mode.

### (3) Hyperlapse Speed

Change the rate by which the video is sped up in Hyperlapse Mode.

- ① To adjust the Hyperlapse speed, first ensure the camera is in Hyperlapse Mode. Then, tap the “Resolution” icon to access its settings.

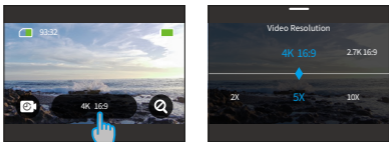

- ② Select your preferred Hyperlapse speed from the available options.



- ① **Resolution:** 4K/2.7K/1440P/1080P
- ② **Hyperlapse Speed:** 30X/15X/10X/5X(default)/2X
- ※ This feature is only available in HyperLapse Video mode.

### (4) Slow Motion Speed

Change the rate by which the video is slowed down in Slow Motion Mode. The Slow Motion Mode allows you to slow things down up to 8X.

- ① To adjust the slow motion speed settings, first ensure the camera is in Slow Motion Mode. Then, tap on the “Resolution” icon to access its settings.

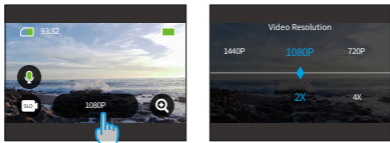

- ② Select your preferred slow motion speed from the available options.



- ① **Resolution:** 1080P/720P/1440P  
 ② **Slow Motion Speed:** 8X/4X/2X(default)

※ This feature is only available in Slow Motion Mode; the resolution options vary based on the selected slow motion speed. For more details, please consult the section: **Video Settings Menu**.

## (5) Image Stabilization

The Brave 8 Lite action camera can efficiently smooth out the lens shakes, resulting in smooth and pristine videos thanks to its Electronic Image Stabilization (EIS4.0) and SuperSmooth Stabilization algorithms. This feature is ideal for capturing scenes involving activities like riding, skating, and handheld use.

**Turn Off:** Turn off Image Stabilization.

**Normal:** The in-camera stabilization mode uses the EIS4.0 algorithm along with a 6-axis gyroscope, ensuring shake-free footage.

**SuperSmooth:** An upgraded in-app image stabilization mode that delivers ultra smooth footage. To achieve this, the SuperSmooth stabilization algorithm is applied via the AKASO GO app.

For SuperSmooth results, record the video with SuperSmooth enabled, then download the stabilized video via the AKASO GO app. Detailed instructions can be found in the section: **App Download & Wifi Connection** → **Album** → **Download Supersmooth Videos**.

To adjust the Image Stabilization settings, simply tap this option.

Options: Turn off / Normal / SuperSmooth.

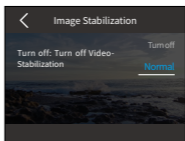
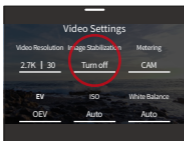

※ Image Stabilization is available in Video mode only; the zoom feature is disabled when Image Stabilization is active; certain resolutions are not available for Image Stabilization. For more details, please consult the section: **Resolution Availability for Video Recording**.

## (6) Metering

The Brave 8 Lite action camera offers diverse metering modes to optimize your shot based on different scenes. Choose from five distinct modes:

**CAM (Central Average Metering)**: Prioritizes the scene's center but also considers surrounding areas. Best for scenes with uniform lighting conditions.

**AM (Average Metering)**: Sometimes referred to as matrix metering, this mode evaluates the entire scene's brightness, ensuring well-balanced exposure and avoiding overexposure, especially in evenly lit settings.

**CM (Central Metering)**: Emphasizes the scene's center, making it ideal for selfies or close-up shots, like flowers.

**SM (Spot Metering)**: Targets a specific spot in the scene to determine exposure, perfect for detailed close-ups.

**AFM (AI Facial Metering)**: A smart mode that adjusts exposure based on detected

facial features, enhancing selfies.

To change Metering settings, tap the "Metering" option.

Options: CAM (default)/AM/CM/SM/AFM.

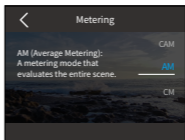
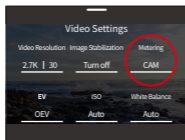

## (7) EV

EV (Exposure Value) lets you adjust the brightness of your photos and videos. A higher EV value creates a brighter image, while a lower value results in a darker image.

Options: 3.0/2.5/2.0/1.5/1.0/0.5/0 (default)/-0.5/-1.0EV/-1.5/-2.0/-2.5/-3.0.

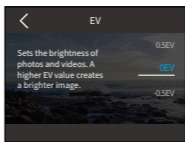

## (8) ISO

ISO controls the image sensor's sensitivity to light. A higher ISO increases sensitivity, making it valuable in dimly lit conditions, though it may introduce graininess. A lower ISO is ideal for bright conditions, producing clearer images with reduced noise.

Options: Auto (default)/100/200/400/800/1600/3200.

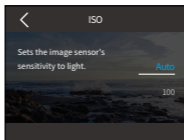
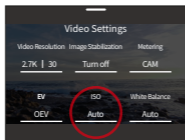

## (9) White Balance

White Balance fine-tunes the color temperature of your videos and photos, ensuring optimal color accuracy in both warm and cool lighting conditions.

Options: Auto (default)/2300K/2800K/3200K/4000K/4500K/5000K/5500K/6000K /6500K.

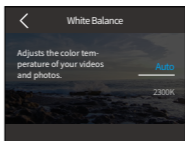
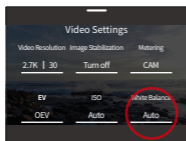

## (10) Sharpness

Sharpness adjusts the sharpness of your scene's elements to capture fine details, thereby enhancing the overall image or video quality.

Options: 0/1/2/3 (default) /4/5/6.

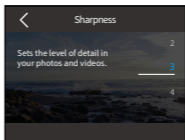
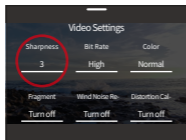

## (11) Bit Rate

Bit Rate directly influences both the file size and image quality. A higher bit rate yields superior image quality but results in larger files.

Options: High (default)/Medium/Low.

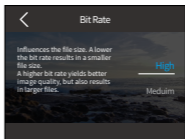
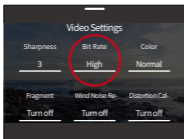

## (12) Color

Choose the tonal quality for your photos or videos to enhance their appeal.

Options: Normal (default)/Vivid.

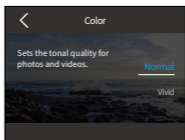
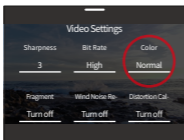

※ To avoid reddish or bluish images due to improper settings, we recommend you set the Color to "Normal" before recording normal videos.

## (13) Fragment

**Clip:** Set your camera to record videos for 15 or 30 seconds.

**Loop Video:** The camera will continuously record 180s of videos. When the Micro SD is full, old video files will be overwritten by new ones to ensure continuous recording.



Options: Turn Off (default)/15S/30S/180S Loop.

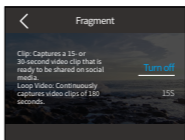
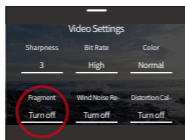

※ This feature is available in Video mode only. Some resolutions are not available for the 180S setting. For more details, please consult the section: **Resolution Availability for Video Recording**.

#### (14) Wind Noise Reduction

Wind Noise Reduction efficiently reduces noise produced during video recording, allowing for better audio quality, making it ideal for use in riding.

Options: Turn off (default)/Turn on.

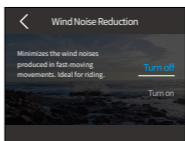
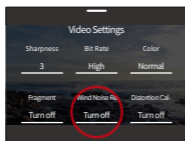

#### (15) Distortion Calibration

Correct the fisheye effect that can occur in wide-angle captures, providing images without distortion.

Options: Turn off (default)/Turn on.

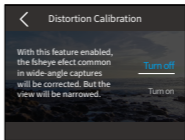
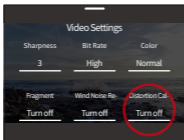

※ Some resolutions are not available for this feature. For more details, please consult the section: **Resolution Availability for Video Recording**.

## (16) HindSight

HindSight can capture footage up to 15 seconds before you press the Shutter button, ensuring you never miss a moment.

Imagine you're out fishing and want to ensure you don't miss the whole exciting moment when a fish grabs your bait. With HindSight enabled beforehand, you do not need to press the Shutter button until the moment has just happened, this feature will save the video before you press the Shutter button and continue recording until you turn off HindSight.

- ① To enable the HindSight feature, tap the "HindSight" option to access its settings screen and select the "Turn on" option.

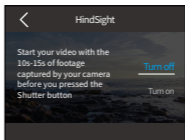
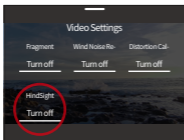

- ② Once activated, return to the preview screen. The camera will start calculating for a period of 10 to 15 seconds. You can press the Shutter button when the right moment had just occurred. The camera will start recording, save the pre-recorded video, and continue recording until you cancel HindSight.

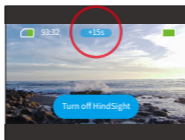

- ③ To halt the recording, simply press the Shutter button again or tap the “Turn off HindSight” option.

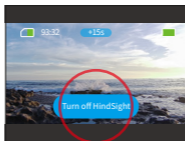

### Tips:

- ① HindSight is available only in Video mode.
- ② Make sure you have configured the settings you want before starting HindSight. You won't be able to change settings once HindSight is turned on.
- ③ Using this feature will consume more power. So disable HindSight if not needed.

## 6.3 Video Settings Menu

Menu		Video	Time Lapse Video	Hyperlapse	Slow Motion	HDR Video
Video-Resolution	16:9	4K60/4K30/ 2.7K120/2.7K 60/2.7K30/10 80P200/1080 P120/1080P6 0/1080P30	4K/ 2.7K/ 1080P	4K/ 2.7K/ 1080P	2.7K4X/ 2.7K 2X/ 1080P 8X/ 1080P 4X/ 1080P 2X/ 720P 8X/ 720P 4X	4K30
	4:3	4K30/2.7K90/ 2.7K60/2.7K3 0/1440P180/ 1440P120/14 40P90/1440P 60/1440P30	4K/2.7K/1440P	4K/2.7K/1440P	1440P 4X/ 1440P 2X	/
Time Lapse Interval	/	2s/5s (default) /10s/30s/1m in/2min/5min /10min/30m in/1h			/	/
Hyperlapse Speed	/	/	/	30X/15X/10X /5X(default)/2X	/	/
Image Stabilization	Turn off (default)/ Normal/ SuperSmooth	/	/	/	/	/
Metering	CAM(default)/AM/CM/SM/AFM					
EV	3.0EV/2.5EV/2.0EV/1.5EV/1.0EV/0.5EV/0EV(default)/-0.5EV/-1.0EV/-1.5EV/- 2.0EV/-2.5EV/-3.0EV					
ISO	Auto(default)/100/200/400/800/1600/3200/6400					
White Balance	Auto(default)/2300K/2800K/3200K/4000K/4500K/5000K/5500K/6000K/6500K					
Sharpness	0/1/2/3(default)/4/5/6					
Bit Rate	High(default)/Medium/Low					



Color	Normal (default) /Vivid				
Fragment	Turn off (default)/ 15S/30S/ 180S Loop	/	/	/	/
Wind Noise Reduction	Turn off (default)/ Turn on	/	/	/	/
Distortion Calibration	Turn off (default)/ Turn on	Turn off (de- fault)/Turn on	Turn off (de- fault)/Turn on	Turn off (de- fault)/Turn on <b>Note:</b> Available in the 2X setting only.	/
HindSight	Turn off (default)/ Turn on	/	/	/	/

## 6.4 Resolution Availability for Video Recording

When the camera is recording videos or switched from the horizontal screen for vertical shots, resolution options may differ based on specific settings. Refer to the table below for a detailed breakdown:

Resolution		Image Stabilization		Fragment 180S Loop	Distortion Calibration	Vertical Mode
NTSC	PAL	Normal	Super-Smooth			
4K60 16:9	4K50 16:9	X	√	X	X	X
4K30 16:9	4K25 16:9	√	√	√	√	√
4K30 4:3	4K25 4:3	X	√	√	X	√
2.7K120 16:9	2.7K100 16:9	X	√	X	X	X
2.7K60 16:9	2.7K50 16:9	X	√	X	√	X
2.7K30 16:9	2.7K25 16:9	√	√	√	√	√
2.7K90 4:3	2.7K75 4:3	X	√	√	X	√



2.7K60 4:3	2.7K50 4:3	X	√	√	X	√
2.7K30 4:3	2.7K25 4:3	√	√	√	√	√
1440P180 4:3	1440P150 4:3	X	√	X	X	X
1440P120 4:3	1440P100 4:3	X	√	X	X	√
1440P90 4:3	1440P75 4:3	X	√	√	X	√
1440P60 4:3	1440P50 4:3	√	√	√	√	√
1440P30 4:3	1440P25 4:3	√	√	√	√	√
1080P200 16:9	1080P200 16:9	X	√	X	X	√
1080P120 16:9	1080P100 16:9	X	√	√	X	√
1080P60 16:9	1080P50 16:9	√	√	√	√	√
1080P30 16:9	1080P25 16:9	√	√	√	√	√

## 7. Photo

### 7.1 Photo Modes

The camera offers two primary photo modes: **Photo** and **Time Lapse Photo**.

- ① To choose a photo mode, tap the Mode icon in the bottom left corner to enter the mode menu, then choose “**Photo**”, and swipe left or right to navigate between the two options.

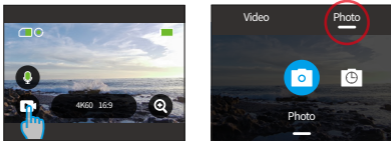

- ② Once you've selected your mode, either tap and swipe up at the screen's bottom to return to the preview screen or wait 5 seconds for the camera to automatically transition to the chosen mode.

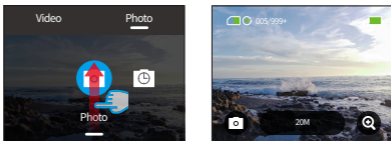

- ③ On the preview screen, tap and swipe up from the bottom to access the photo settings.

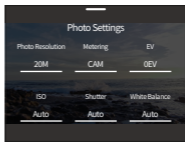
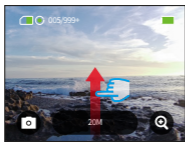

- ④ On this screen, swipe up to access more settings tailored to the chosen photo mode. For a detailed list of these settings, refer to the **Photo Settings Menu** section.

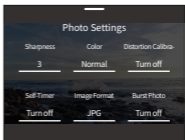
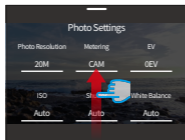

- ⑤ Once configuration is complete, swipe down to return to the preview screen.





## (1) Photo Mode

In Photo mode, press the Shutter button to take a photo at the preset photo resolution.

- ① Choose "Photo" to enter Photo Mode.

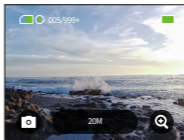
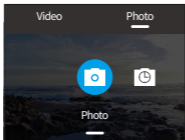

- ② Tap the Resolution icon to access the quick menu, and swipe left or right to configure the resolution settings.

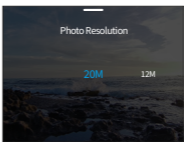

## (2) Time Lapse Photo Mode

In this mode, when you press the Shutter button, the camera will continuously take photos after the set interval till you press the Shutter button again.

For instance, when you set "Time Lapse Interval" to "5 seconds", then press the Shutter button, the camera will count down 5 seconds and continuously take photos. To stop capturing, press the Shutter button again.

- ① Choose "Time Lapse Photo" to enter Time Lapse Photo Mode.

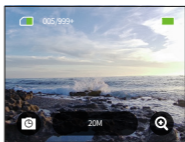
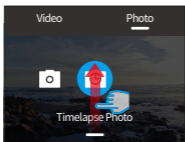

- ② Swipe left or right to select a desired photo resolution or a time lapse interval.



- **Photo Resolution:** 20MP/12MP
- **Time Lapse Interval:** 0.5s/1s/2s/5s/10s/30s/1min/2min/5min/10min/30min/1h

Swipe left or right to select a desired photo resolution or a time lapse interval.

**Note:** The Shutter setting cannot be adjusted in Time Lapse Photo mode; all Time lapse photos are output in JPG format.

## 7.2 Photo Settings

Fine-tune your settings to capture the perfect shot.

- ① To begin, ensure your camera is in Photo mode, then swipe up to access the Photo Settings screen.

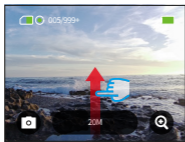

- ② Scroll to explore a wide range of available options.

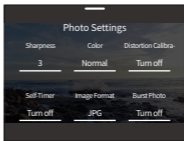
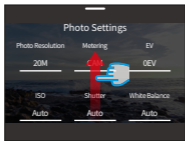

- ③ Once you've made your desired adjustments, tap the "<" icon in the upper left corner to save your changes and return to the Photo Settings screen.

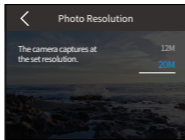

④ Swipe down to go back to the preview screen.

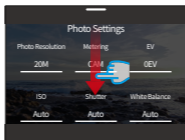

## (1) Photo Resolution

This camera is capable of capturing 20MP photos. While higher resolutions yield clearer and more detailed photos owing to the increased pixel count, they also produce larger file sizes.

To adjust the resolution, tap the “Photo Resolution” option to access its settings screen.

Options: 20M(default)/12M.

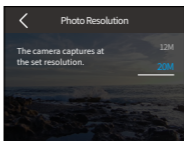
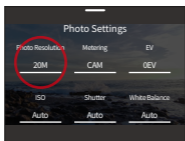

## (2) Metering

The Brave 8 Lite action camera offers diverse metering modes to optimize your shot based on different scenes. Choose from five distinct modes:

**CAM (Central Average Metering):** Prioritizes the scene's center but also considers surrounding areas. Best for scenes with uniform lighting conditions.

**AM (Average Metering):** Sometimes referred to as matrix metering, this mode evaluates the entire scene's brightness, ensuring well-balanced exposure and avoiding overexposure, especially in evenly lit settings.

**CM (Central Metering):** Emphasizes the scene's center, making it ideal for selfies or close-up shots, like flowers.

**SM (Spot Metering):** Targets a specific spot in the scene to determine exposure, perfect for detailed close-ups.

**AFM (AI Facial Metering):** A smart mode that adjusts exposure based on detected facial features, enhancing selfies.

To change Metering settings, tap the “Metering” option.

Options: CAM (default)/AM/CM/SM/AFM.

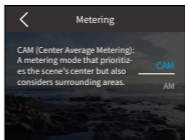

### (3) EV

EV (Exposure Value) lets you adjust the brightness of your photos and videos. A higher EV value creates a brighter image, while a lower value results in a darker image.

Options: 3.0EV/2.5EV/2.0EV/1.5EV/1.0EV/0.5EV/0EV(default)/-0.5EV/-1.0EV/-1.5EV/-2.0EV/-2.5EV/-3.0EV.

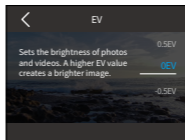
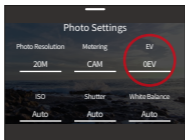

#### (4) ISO

ISO allows you to adjust the sensitivity of the image sensor to light.

Options: Auto (default)/100/200/400/800/1600/3200/6400.

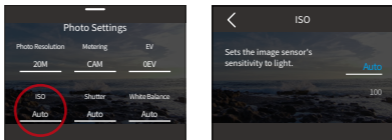

#### (5) Shutter

Determine the length of time that a shutter remains open. By keeping the shutter open throughout the desired exposure time, the camera can continue recording. This feature is ideal for capturing scenes involving low-light conditions, illuminated subjects, or water elements.

Options: Auto(default), 5s, 2s, 1/125s, 1/250s, 1/500s, 1/1000s, 1/2000s.

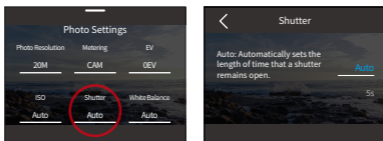

※ This feature is available in Photo mode only.

#### (6) White Balance

White Balance fine-tunes the color temperature of your videos and photos, ensuring optimal color accuracy in both warm and cool lighting conditions.

Options: Auto (default)/2300K/2800K/3200K/4000K/4500K/5000K/5500K/6000K/6500K.

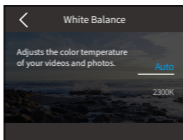
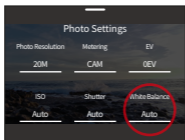

## (7) Sharpness

Adjust the sharpness of your scene's elements to capture fine details, thereby enhancing the overall image or video quality.

Options: 0/1/2/3 (default)/4/5/6.

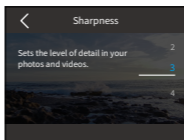
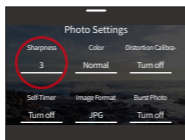

## (8) Color

Choose the tonal quality for your photos or videos to enhance their appeal.

Options: Normal (default)/Vivid.

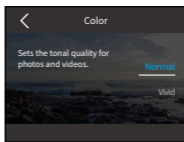
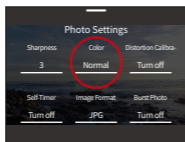

※ To avoid reddish or bluish images due to improper settings, we recommend you set the Color to "Normal" before capturing photos.

## (9) Distortion Calibration

Correct the fisheye effect common in wide-angle captures, providing images without distortion.

Options: Turn off (default)/Turn on.

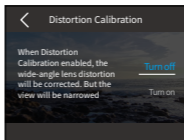
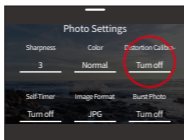

## (10) Self-Timer

This option allows you to set the countdown time in Photo mode.

Options: Turn off (default)/1s/3s/5s/10s/30s.

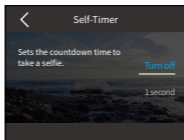
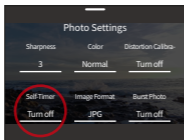

※ This feature is available in Photo mode only.

## (11) Image Format

Image format refers to the output format of a photo. This camera supports two formats: JPG and JPG+RAW.

JPG provides a compressed format that minimizes file size at the expense of some detail. In contrast, RAW maintains the image's full data without any compression, ensuring maximum quality while taking up more storage space than JPG images.

Options: JPG/JPG+RAW.



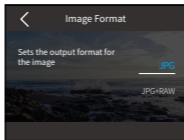

## (12) Burst Photo

Burst Photo mode lets you capture up to 8 shots per second with the option to shoot JPG. This setting decides how many consecutive shots the camera captures with a single Shutter press.

Options: Turn off (default)/3/5/10.

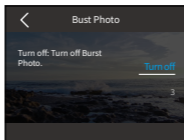
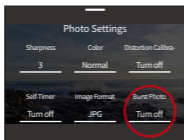

※ Burst Photo is available in Photo mode only, and images are output in JPG format. Ensure camera stability throughout the entire burst duration when using this mode.

## 7.3 Photo Settings Menu

Menu	Photo	Time Lapse Photo
Photo Resolution	20MP(default)/12MP	
Metering	CAM(default)/AM/CM/SM/AFM	
EV	3.0EV/2.5EV/2.0EV/1.5EV/1.0EV/0.5EV/0EV(default)/-0.5EV/-1.0EV/-1.5EV/-2.0EV/-2.5EV/-3.0EV	
ISO	Auto(default)/100/200/400/800/1600/3200/6400	
Shutter	Auto(default), 5s, 2s, 1/125s, 1/250s, 1/500s, 1/1000s, and 1/2000s	/
White Balance	Auto(default)/2300K/2800K/3200K/4000K/4500K/5000K/5500K/6000K/6500K	
Sharpness	0/1/2/3(default)/4/5/6	
Color	Normal (default) /Vivid	
Distortion Calibration	Turn off (default)/ Turn on	
Self-Timer	Turn off(default)/1s/3s/5s/10s/30s	/
Image Format	JPG(default)/JPG+RAW	
Burst Photo	Turn off(default)/3/5/8	/



## 8. System Settings

Dive into the System Settings to adjust your Preferences and General Settings.

### 8.1 Preferences

#### ① Setting Preferences

A. Ensure the camera is on the preview screen, then swipe down to access the quick menu.



B. Tap the "Preferences" option to access the preferences settings screen for quick setup.

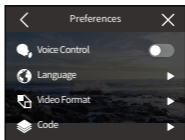

#### ② Quick Settings Guidance

To exit any screen, tap the "<" icon in the upper left corner.

To save and exit current settings, tap the "<" icon in the upper left corner.

To return to the preview screen, tap the "X" icon in the upper right corner.



## (1) Voice Control

Choose to turn the voice control feature on or off. With Voice Control enabled, you can issue any supported voice command to the camera. The camera will respond to the given voice commands and execute various functions.

For example, saying "AKASO Take Photo" to the camera will prompt it to snap a picture. For a comprehensive list of voice commands, see the section **System settings** → **General Settings** → **Voice Command** or check it through **Preferences** → **General Settings** → **Voice Command** on the camera.

To turn this feature on or off, tap the Voice Control slider.

**Tip:** You can also enable the voice control feature on the quick menu.

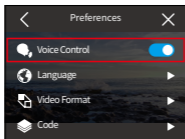

Voice Control On

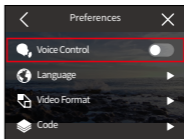

Voice Control Off

## (2) Language

Choose the desired system language for your camera interface.

Options: 简体中文/繁體中文/English (default)/Deutsch/日本語/Français/Español/Italiano/한국어/Русский/Português/Malese/Filipino/Indonesia.

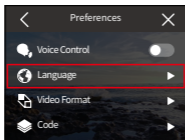

### (3) Video Format

Determine your video format preference.

Options: NTSC(default)/PAL.

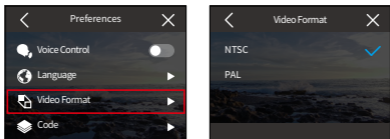

※ Resolutions and frames vary based on the video formats. For more details, please consult the section **Resolution Availability for Video Recording**.

### (4) Code

Select between H.265 and H.264 video codecs, each offering different image effects and compression ratios. H.265 videos take up less storage space than H.264 videos due to their more efficient compression algorithms.

Options: H.264(default)/H.265.

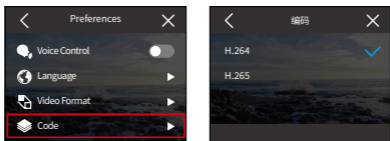

### (5) Wireless Connection

Connect your action camera to the AKASO GO app using the camera's built-in Wifi. For a comprehensive guide, refer to the section: **App Download & Wifi Connection** → Camera Wifi.

## ① Wireless Connection

Turn Wifi on or off with a simple slide of the switch.

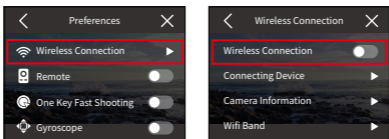

※ If Wifi isn't connected within 3 minutes, it will auto-disconnect. Enable Wifi again to reconnect.

## ② Connecting Device

This option reminds you of installing the AKASO GO app to connect to your camera via Wifi.



## ③ Camera Information

View the Wifi SSID and password here.



#### ④ Wifi Band

Choose between the 2.4G and 5G Wifi bands. While 2.4G Wifi band offers better range and penetration, its stability may fluctuate. On the other hand, 5G offers faster speeds and enhanced stability but might not work as well over longer distances.

Tap the Wifi Band option to choose from 2.4G and 5G.

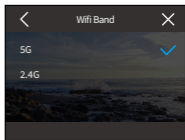
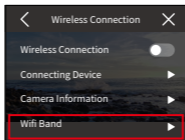
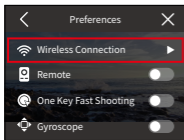

※ If your smartphone device doesn't support 5G, select the 2.4G option.

#### (6) Remote

By enabling Remote, you can pair your camera with the included remote for remote operation.

Options: Turn off (default)/Turn on.

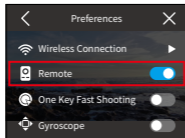

Remote On

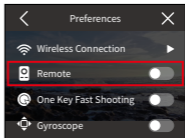

Remote Off

## (7) One Key Fast Shooting

With this feature enabled, the camera will automatically turn on and start recording as soon as you press the Shutter button in the power-off state. To stop recording, simply press the Shutter button again. The camera will then save the video file and power off.

To turn this feature on or off, tap the One Key Fast Shooting slider.

**Tip:** You can also turn this feature on or off on the quick menu.

Options: Turn off (default)/Turn on.

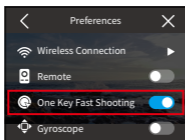

One Key Fast Shooting On

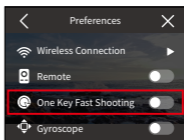

One Key Fast Shooting Off

## (8) Gyroscope

The camera's built-in 6-axis gyroscope can detect how you hold the camera, allowing for a more enjoyable capture experience. With Gyroscope enabled, the camera intuitively captures vertical shots when held upright, and switches to wide screen when held sideways.

Options: Turn off (default)/Turn on.

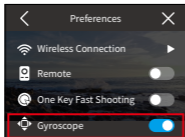

Gyroscope On

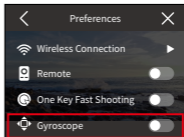

Gyroscope Off



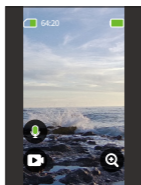

9:16  
Vertical Capture

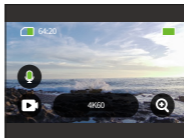

16:9  
Horizontal Capture

**Note:** When the camera is switched to vertical screen, the user interface will also be horizontally displayed; 4K and 2.7K resolutions are not available for vertical capture.

## 8.2 General Settings

Navigate to the General Settings screen to tailor your camera's setup by tapping the "General Settings" option.

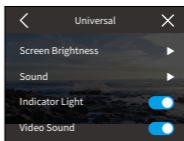
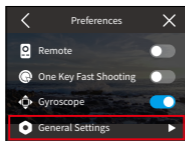

### (1) Screen Brightness

Easily adjust the screen's brightness.

① Access the brightness settings by selecting "Screen Brightness".

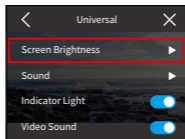

- ② Fine-tune the brightness level between 0% and 100% using the slider or the “+” / “-” icons.

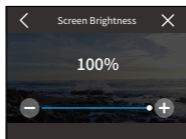

## (2) Sound

Customize the camera's volume, key tone, beep tone, and photo beep tone by tapping the “Sound” option.

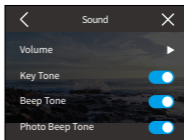
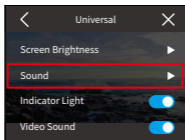

## ① Volume

Adjust the overall volume between 0% and 100% by selecting the “Volume” option.

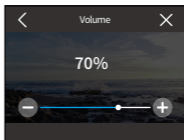
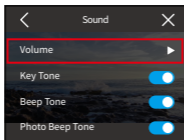

## ② Key Tone

Key Tone refers to the sound emitted when you press the camera's buttons.

To turn the key tone on or off, tap on the slide switch of Key Tone.

Options: Turn off (default)/Turn on.

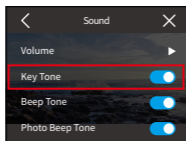

Key Tone On

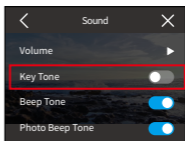

Key Tone Off

## ③ Beep Tone

Beep Tone refers to the sound emitted by the camera during operations like powering on/off or starting/stopping recording.

Options: Turn off (default)/Turn on.

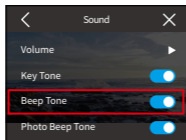

Beep Tone On

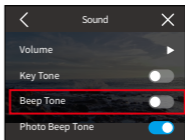

Beep Tone Off

## ④ Photo Beep Tone

Photo Beep Tone refers to the sound emitted when the camera takes a photo.

Options: Turn off (default)/Turn on.

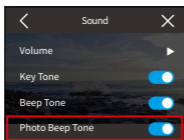

Photo Beep Tone On

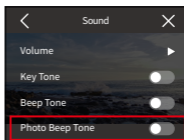
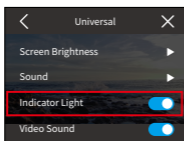

Photo Beep Tone Off

### (3) Indicator Light

The Brave 8 Lite action camera features two indicator lights: one positioned in the upper left corner of the touchscreen, and the other in the bottom right corner of the front screen. If you prefer not to have the indicator visible, it can easily be disabled in this setting.

Options: Turn off (default)/Turn on.



Indicator On

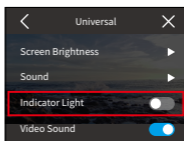

Indicator Off

### How Do Indicator Lights Work?

The camera's indicator lights will illuminate or flash based on your operations.

Operation	Descriptions	Touchscreen	Front Screen
Power on	Press and hold the Power button from an off state.	Green flashes twice then turns off.	Green flashes twice then turns off.
Power off	Press and hold the Power button when on.	Green flashes 3 times-then turns off.	Green flashes 3 times then turns off.

Charge	Not charging	Red turns off.	Red turns off.
	Charging	Red remains on.	Red turns off.
	Fully charged	Red turns off.	Red turns off.
Recording	Start: In Video mode, press the Shutter button.	Green flashes slowly.	Green flashes slowly.
	Stop: While recording, press the Shutter button again.	Green turns off.	Green turns off.
Shooting	In Photo mode, press the Shutter button.	Green flashes once then turns off.	The green indicator flashes once and then blacks out.
Card insertion/ removal	With the camera off, insert or remove the Micro SD card. (Caution: Handle with care to prevent damage.)	Green flashes once then turns off.	Green flashes once then turns off.
Prompt of inserting the card	Press the Shutter in Video or Photo mode without an SD card.	Green flashes 3 times then turns off.	Green flashes 3 times then turns off.
Wifi connection	Wifi on but not connected to the app.	Flashes rapidly.	Red flashes rapidly.
	Wifi connected to the app.	Green remains on.	Red remains on.
Recording via the app	Start: With camera connected to AKASO GO app in Video mode, tap Shutter in the app.	Green remains on.	Red and green alternately flash.
	Stop: While recording, tap Shutter in the app.	Green remains on.	Red remains on
Shooting via the app	With camera connected to AKASO GO app in Photo mode, tap Shutter in the app.	Green flashes once then remains on.	Red and green flash once, then red stays on.

#### (4) Video Sound

When Video Sound is disabled, the camera will record video without audio.

Options: Turn off (default)/Turn on.

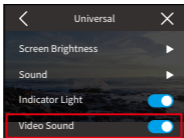

Video Sound On

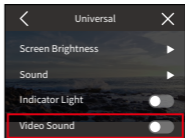

Video Sound Off

※ Video Sound is available in Video mode only. It will be disabled by default when the camera is in Time Lapse Video, Hyperlapse, Slow Motion, and HDR modes.

#### (5) Auto Power Off

Set the duration of inactivity after which the camera automatically powers off. If not operated within the chosen duration, the camera will shut down.

Options: Never/2 Min/5 Min/10 Min/20 Min/30 Min.

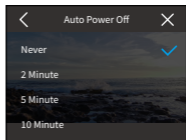
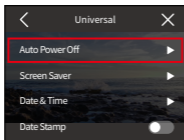

## (6) Screen Saver

Determine when the camera's display should go dormant to conserve battery. If you need the screen back on, just tap it or press any button.

Options: Never/15 Sec/30 Sec/1 Min/2 Min/5 Min.

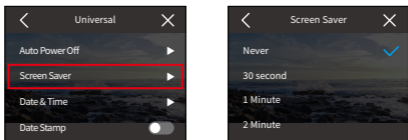

※ Even with the screen off, you can still press the camera's buttons and use the voice control feature. The camera also continues to record even when the screen is off.

## (7) Date & Time

Set your camera's date and time manually or sync it with your phone through the AKASO GO app.

Tap the "Date & Time" option to access its settings.

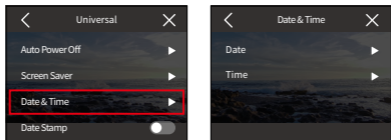

## ① Date

You can set the camera's date by accessing its settings screen.

- Tap "Date" to access its settings screen.
- Swipe up or down to choose from the settings, then tap the "✓" icon in the upper right corner. To exit, use the "<" icon in the upper left corner.

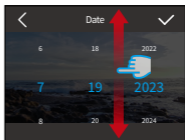
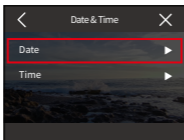

## ② Time

You can set the camera's time by accessing its settings screen.

- To set the time of the camera, first tap on the "Time" option to access its settings screen.
- Second, swipe up or down to choose from the settings, then tap on the "✓" icon in the upper right corner. You will be successfully set the time. If you want to quit the setting, simply tap on the "<" icon in the upper left corner to exit the settings screen.

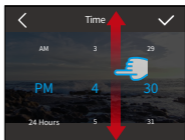
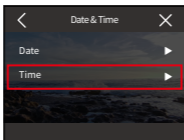

※ This camera supports 12-Hour and 24-Hour time systems.



## (8) Date Stamp

When Date Stamp is enabled, a time and date watermark will be added to the video or photo.

Options: Turn off (default)/Turn on.

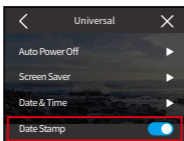

Date Stamp On

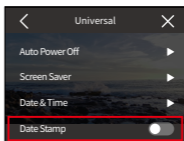

Date Stamp Off

## (9) Format

Erase all data on your memory card. Formatting will delete all the media files stored in the memory card. Ensure important files are saved elsewhere before proceeding.

To format the SD card, you can tap on the "Format" option to access the formatting screen which provides two options.

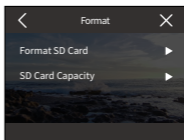
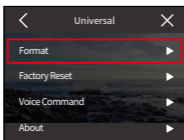

### ① Format SD Card

On the formatting screen, you can tap on the "Format SD Card" option to confirm or cancel formatting the SD card.

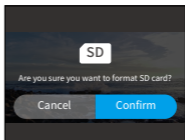
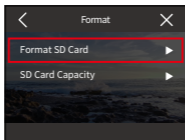

**Warm tip:** Always format new SD cards in the camera before use.

## ② SD Card Capacity

To check the total, used, and remaining capacity of the SD card, you can tap on the "SD Card Capacity" option.

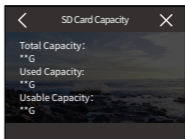
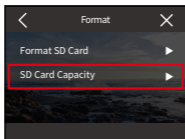

## (10) Factory Reset

This option will reset all the settings to the default values, and disconnect all the connections.

To reset your camera, you can tap on the "Factory Reset" option to confirm or cancel factory reset.

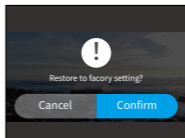
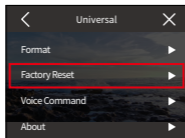

※ The camera will enter the start-up settings screen after the factory reset. You can resume using the camera after setup.

## (11) Voice Commands

Check all the supported voice commands under this setting. The camera will respond to the given voice commands and execute various functions. For example, saying "AKASO Power Off" to the camera will prompt it to turn off.

No.	Voice Commands	Descriptions
1	AKASO Video Start	Brave 8 Lite action camera starts recording video.
2	AKASO Stop Video	Brave 8 Lite action camera stops recording video.
3	AKASO Take Photo	Brave 8 Lite action camera takes a photo.
4	AKASO Power Off	Brave 8 Lite action camera shuts down.

### Tips:

- (1) This camera only supports voice commands in Chinese, English, German, Spanish, Italian, French, and Japanese. It will only respond to English voice commands if the system language is not set to one of the supported languages.
- (2) Stop video recording before giving a new command.
- (3) Speak clearly and naturally at a normal speed. There is no need to slow down.
- (4) Emphasize the end of the command.
- (5) Performance might vary with distance, environmental noise, and wind. Ensure the device is kept clean and clear of debris.
- (6) Voice commands are most effective within 3 meters.

## (12) About

View details about your camera, including brand, model, and firmware, by tapping the "About" option.

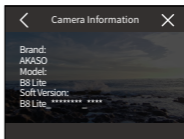
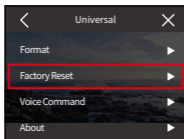

## 9. Album

The album allows you to view all the video and photo files stored on the memory card.

### 9.1 Album Access

- (1) Swipe left from the preview screen to enter the playback screen, then tap the "Square" icon  in the upper left corner to access the album screen.

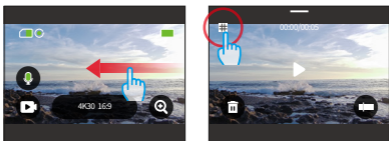

- (2) Tap "Video" or "Photo" to enter the video or photo set for file playback.

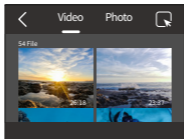

## 9.2 Album Screen

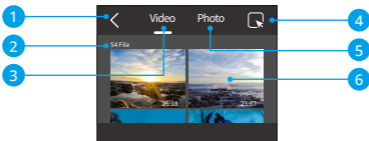

- ① Exit Album: Return to the preview screen.
- ② File Count: Display the total number of files in the current set.
- ③ Video Set: Swipe up to view more video files.
- ④ Delete File: Delete the selected file.
- ⑤ Photo Set: Swipe up to view more photo files.
- ⑥ File Thumbnail: Tap to play or view the file in full screen.

## 9.3 Video Playback

### (1) Playback Videos

- ① From the album screen, tap "Video" to enter the video set.
- ② Scroll through the video files, and tap one file to see it in full-screen view.
- ③ Tap the playback icon, and it will play.

**Tip:** On the current file screen, you can navigate among videos by swiping left or right.

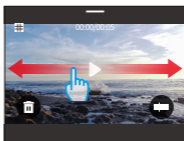
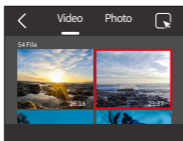

## (2) Video Screen



- ① Return to the album screen
- ② Delete the current file
- ③ Swipe down to return to the preview screen
- ④ Current playback time
- ⑤ Play/Pause
- ⑥ Playback progress bar

## 9.4 Photo Playback

### (1) Playback Photos

- ① From the album screen, tap "Photo" to enter the photo set.
- ② Scroll through the photo files, and tap one file to see it in full-screen view.
- ③ Tap the playback icon, and it will play.

**Tip:** On the current file screen, you can navigate among photos by swiping left or right.

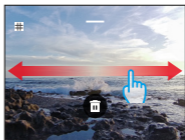
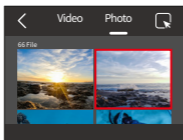

## (2) Photo Screen



- ① Return to the album screen
- ② Delete current file
- ③ Swipe down to return to the preview screen

## 9.5 File Deletion

### (1) Delete Files from the Album Screen

- ① From the album screen, tap the Square icon in the upper right corner to select file (s) you want to delete.

**Tip:** You can tap the icon at the top to select all files for deletion. Additionally, individually select the files you wish to delete, and it will display the number of selected files.

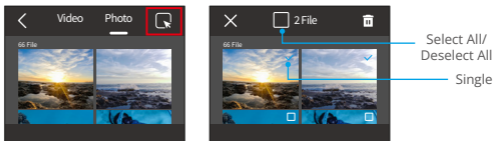

- ② Tap the Delete icon  in the upper right corner followed by the "Confirm" option to complete the deletion of the selected files.



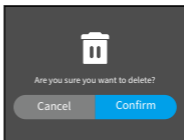
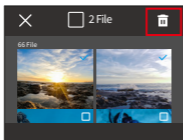

## (2) Delete Files on the Video Screen

On the Video screen, tap the Delete icon  in the bottom left corner of the current video file, and select the “Confirm” option to complete the deletion of the selected file.

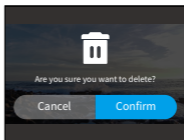

## (3) Delete Files on the Photo Screen

On the Photo screen, tap the Delete icon  at the bottom of the current photo file, and select the “Confirm” option to complete the deletion of the selected file.

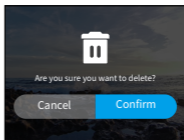
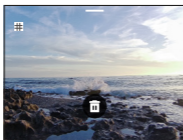



## 10. Data Transmission

### 10.1 Transfer Files to A Computer

#### Method 1: Transfer files via a card reader

- ① Ensure the camera is turned off, then carefully remove the SD card.
- ② Insert the SD card into the card reader.
- ③ Connect the card reader to your computer's USB port.
- ④ Copy files to your computer for playback or editing.

#### Method 2: Transfer files via a data cable

- ① Connect your camera to the computer using a USB data cable.
- ② When prompted, select "USB Storage" as your connection preference. You'll be notified that your camera is now connected to the computer.

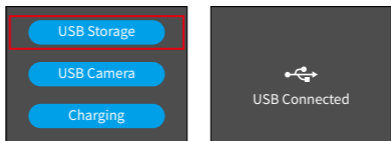

- ③ Navigate to the memory card drive on your computer, then transfer files as desired for playback or editing.

※ Ensure you're using a USB data cable, not just a charging cable, to enable data transfer.



## 10.2 Using the Brave 8 Lite as a Web Cam

Webcam mode allows you to use the Brave 8 Lite as a Webcam. Once activated, it can capture and transmit live video or images in real-time over the internet, ideal for video conferencing, online streaming, and live chatting. To do this, follow the steps below:

- ① Connect your camera to the computer using a USB data cable.
- ② When prompted, select “USB Camera” as your connection preference.

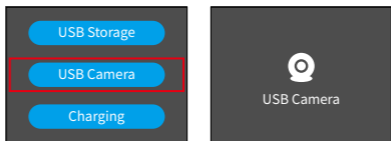

- ③ Activate your camera as a Webcam. (**Note:** Some computers may require enabling the “USB Video Device” setting first.)

※ As a Webcam, the camera's default recording resolution is 4K at 30FPS. Adjust resolution settings using a Webcam tool on your computer.

※ Ensure you're using a Type-C data cable, not just a charging cable, to enable data transfer.

# 11. App Download & Wifi Connection

## 11.1 Camera Wifi

The camera Wifi works to connect the camera to the AKASO GO app to preview or transfer files.

※ The camera Wifi will not be connected to the internet.

## 11.2 Features of the AKASO GO App

- (1) View the camera's status on your phone
- (2) Remotely control the camera with your phone.
- (3) Preview videos and photos stored on the SD card.
- (4) Edit or share videos or photos captured by your camera.
- (5) Update the camera's firmware.

### Tips:

- ① Ensure the camera's Wifi is active before connecting to the AKASO GO app.
- ② The camera cannot be operated in Wifi mode. Exiting the Wifi screen disconnects the camera Wifi automatically.
- ③ While connecting the camera Wifi, a "No Internet Connection" or "Weak Security" notification might appear since the phone's data is paused. Disconnect the app to restore internet access.



## 11.3 Download the AKASO GO App

- (1) To sync your camera with the app, download the AKASO GO app from the App Store (iOS) or Google Play (Android) by searching for "AKASO GO". Alternatively, use the provided QR code:



AKASO GO



iOS



Android

- (2) Access all app features by registering and logging into your AKASO GO account.

## 11.4 Create An Account for the AKASO GO App

- (1) Open the AKASO GO app, then tap "My" in the bottom right corner to enter the registration page.

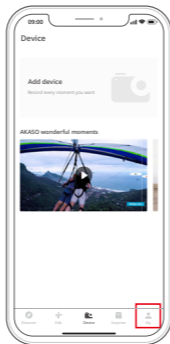

- (2) Tap "Join Now" to enter the required information for login, then tap on the "Log in" option. Now you successfully create the app account.

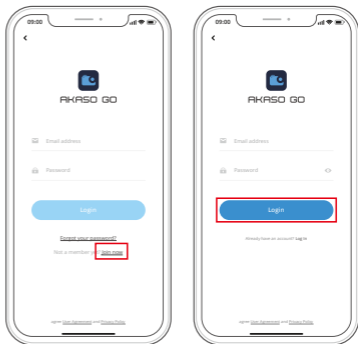

## 11.5 Connect to the AKASO GO App via Wifi

Please follow the instructions below to connect your camera to the AKASO GO App.

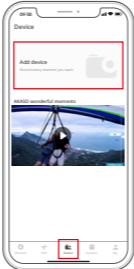
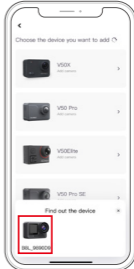
<p>1. Tap the Wifi icon on the quick menu to enable Wifi.</p>	<p>2. Open the AKASO GO app on your smartphone, tap "Device" at the bottom, then tap "Add Device" in the upper left corner.</p>	<p>3. Tap the Brave 8 Lite's Wifi SSID to begin scanning for the camera's Wifi signal. <b>Tip:</b> The Wifi SSID can be found in the camera's Preferences screen.)</p>
		

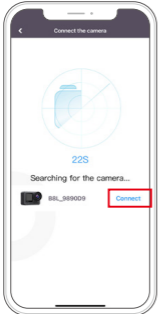
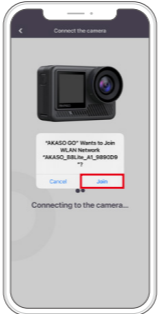
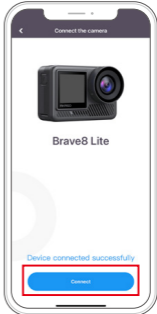

<p>4. Select the "Connect" option in the bottom right corner.</p>	<p>5. Choose the "Join" option in the bottom right corner to establish a connection.</p>	<p>6. Tap the "Connect" option at the bottom to link your camera with the AKASO GO app.</p>
		

### Tips:

- ① If you failed to connect the camera's Wifi, please confirm if you successfully turned on the camera's Wifi. Please tap the "Research" option if you can't find the camera's Wifi.
- ② The screenshots and steps above are for your reference only.

## 11.6 AKASO GO App Menu

### (1) User Interface

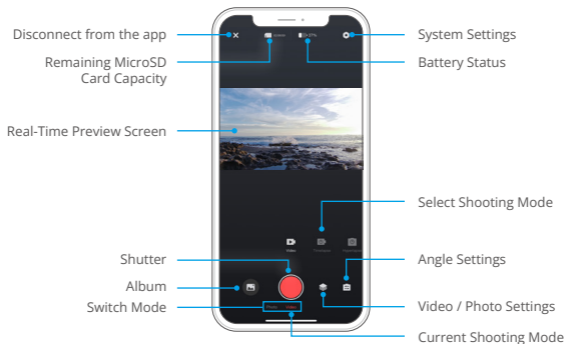

### (2) Video



#### ① Video Modes

The app offers five video modes: Video, Time Lapse Video, Hyperlapse, Slow Motion, and HDR Video.

For detailed information on these modes, refer to the section Video. To choose a video mode, tap "Video" and then swipe left or right.



## ② Video Settings

To access video settings, simply tap on the icon . You can tap on this icon  again to exit the video settings screen.

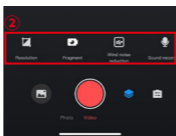
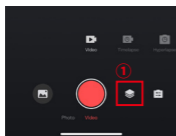

### • Resolution

Resolution defines the image clarity based on its height and width. Higher resolution results in clearer images and larger file sizes.

**Note:** Available resolutions vary based on the select shooting mode. For more on this, see the section: Video Settings Menu.

Options:

-NTSC: 4K30/2.7K30/1440P60/1440P30/1080P120/1080P60/1080P30/ 720P240 /720P120.

-PAL: 4K25/2.7K25/2K50/2K25/1080P75/1080P50/1080P25/720P100/720P75/ 720P50/720P25

### • Fragment

Set the video recording duration. Available only in Video mode.

Options: Off (default)/15S/30S/180S Loop

### • Wind Noise Reduction

Enhance audio quality by reducing wind noise during recording. Available only in Video mode.

### • Video Sound

Toggle this setting to record videos with or without audio. Available only in Video mode.



Options: On/Off (default)

- **Slow Motion Speed**

Adjust the speed for slow-motion videos. Available only in Slow Motion mode.

Options: 1080P 4X/1080P 2X/720P 8X/720P 4X/1440P 2X

- **Hyperlapse Speed**

Determine the rate at which your videos are sped-up. Available only in Hyperlapse mode.

Options: 30X/15X/10X/5X (default)/2X

- **Time Lapse Interval**

Set the frequency for capturing video frames in Time Lapse Video mode. Available only in Time Lapse Video mode.

Options: 2s/5s (default)/10s/30s/1min/2min/5min/10min/30min/1h

### (3) Photo



#### ① Photo Modes

The app offers four photo modes: Photo, Burst Photo, Photo Timer, and Time Lapse Photo.

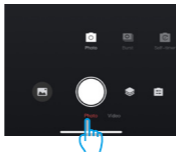
To select a mode, tap on “Photo” and swipe left or right.



## ② Photo Settings

To access the photo settings, simply tap on the icon . You can tap on this icon  again to exit the photo settings screen.

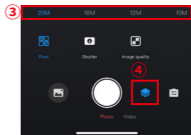
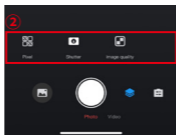
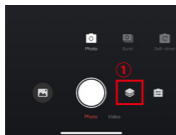

### • Pixel

A larger pixel value results in a higher-resolution, clearer image and bigger photo size.

Options: 20MP(default)/12MP

### • Shutter

Adjust the duration the camera's shutter stays open. Keeping the shutter open throughout the desired exposure time may be useful for low-light scenes, illuminated subjects, or water elements.

Options: Auto (default), 5S, 2S, 1/125S, 1/250S, 1/500S, 1/1000S, 1/2000S

### • Burst

Determine the number of photos taken in Burst mode with a single shutter press. Available only in Burst Photo mode.

Options: 3 Shots (default)/5 Shots/8 Shots

### • Timer

Set the countdown time before the camera takes a photo.

For example, with the timer interval set to "3s", the camera will initiate a 3-second countdown, then automatically activate the shutter to take a photo. Available only in Photo Timer mode.



Options: 1 s/3s (default)/5s/10s/30s

## • Time Lapse Interval

Choose how frequently photos are taken in Time Lapse Photo mode. For instance, if you set the Time Lapse Interval to “3s”, the camera will continuously capture photos every 3 seconds. Available only in Time Lapse Photo mode.

Options: 3s (default)/5s/10s/30s/1min

## • Angle

By tapping on the icon  in the bottom right corner, then tapping on the mixed zoom icon , you can access the angle settings screen. To exit this screen, simply tap on this icon again.

Options: Super Wide Angle/Wide Angle/Portrait Perspective/ Narrow Angle

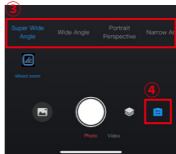
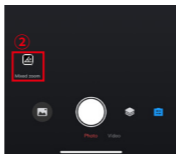
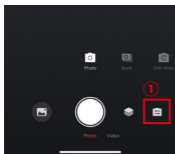

## (4) Album

### ① Accessing the Album

A. Tap the “Album” icon in the bottom left corner to view videos and photos stored on the SD card.

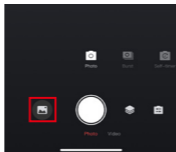

B. Once inside, swipe up to see all files. Select any file to play it.

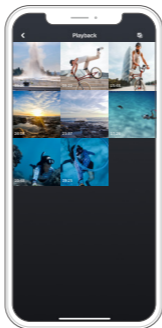

## ② Download Files to Your Phone

You can download video or photo files stored in the memory card via the AKASO GO App.

### A. Download SuperSmooth Videos

To get a SuperSmooth video, you need to enable the SuperSmooth feature to record the video, then download it from the app to your phone by following the steps below.

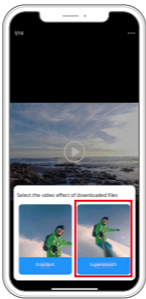
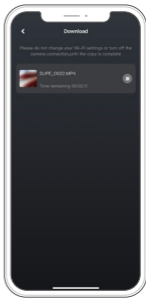
<p>Step 1: Select the desired video, then tap the icon in the upper right corner and choose "Download".</p>	<p>Step 2: Choose "SuperSmooth".</p>	<p>Step 3: After accessing the download screen, wait for the download progress to complete.</p>
		

Step 4: Once it is downloaded successfully, the video is processed by the SuperSmooth Stabilization algorithm.

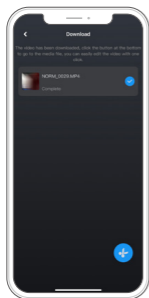

Step 5: Once processed, the video is stored in your phone's album.

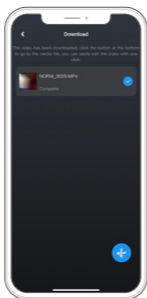



※ Normal videos cannot be downloaded in the same way as SuperSmooth videos since they have not been processed by the SuperSmooth stabilization algorithm.

## B. Download Normal Video or Photo Files

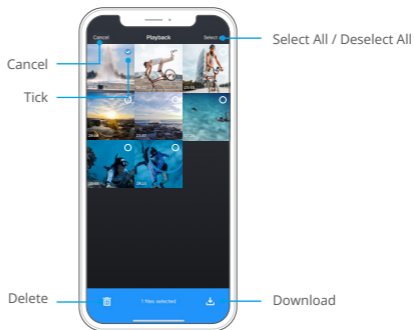
Follow the steps below to download files from the app to your phone.





- After accessing the album, tap on the Select icon in the upper right corner.
  - Select the file  you want to download.
  - Tap on the "Download" icon  in the bottom right corner and confirm the download.
  - The file will be saved to your phone's gallery once the download completes.
- ※ Do not alter Wifi settings or disconnect from the app during download.

### ③ Delete Files on the App

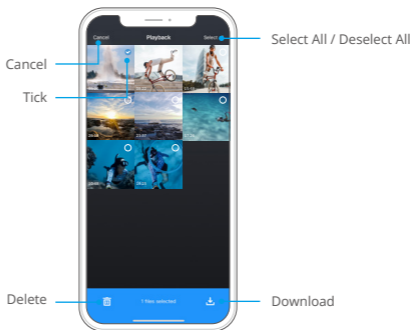
Follow the steps bellow to delete files on the app.



- Access the album and tap the Select icon in the upper right corner.
- Select the file  you want to delete.
- Tap the "Delete" icon  in the bottom left corner and confirm the deletion.
- The selected file is now deleted.

※ Do not alter Wifi settings or disconnect from the app during deletion.



## (5) System Settings

### ① Accessing the System Settings Screen

By tapping on the Settings icon  in the upper right corner, you can access the settings screen of the app.

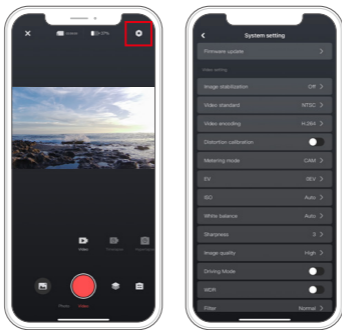

### ② System Settings menu

- **Firmware update**

A firmware update can resolve compatibility issues, improve the camera's functions, and enhance the Wifi connection.

- **Image stabilization**

Image stabilization expertly reduces lens shake, delivering smooth and pristine video quality. This is ideal for capturing scenes involving activities like riding, skating, and handheld use.

**Options:** Off (default)/SuperSmooth

- **Video standard**

Select the video format.

**Options:** NTSC/PAL

- **Video encoding**

Video encoding is the process of converting a raw video file into a compressed format that takes up less storage space. This camera supports both H.265 and H.264 video codecs, each offering different image effects and compression ratios.

- **Metering mode**

Choose the metering mode for different scene.

**Options:** CAM(default)/AM/CM/AFM

- **EV**

EV (Exposure Value) lets you adjust the brightness of your photos and videos. A higher EV value creates a brighter image, while a lower value results in a darker image.

**Options:** 3.0EV/2.5EV/2.0EV/1.5EV/1.0EV/0.5EV/0EV(default)/0.5EV/1.0EV/1.5EV/2.0EV/2.5EV/3.0EV

- **ISO**

ISO allows you to adjust the sensitivity of the image sensor to light.

**Options:** Auto(default)/100/200/400/800/1600/3200/6400

- **White balance**

White Balance fine-tunes the color temperature of your videos and photos, ensuring optimal color accuracy in both warm and cool lighting conditions.

**Options:** Auto (default)/2300K/2800K/3200K/4000K/4500K/5000K/5500K/6000K/6500K

### • Sharpness

Adjust the sharpness of your scene's elements to capture fine details, there by enhancing the overall image or video quality.

Options: 0/1/ 2/3(default)/5/6

### • Image Quality

A higher Image Quality setting directly translates to better image quality, often accompanied by larger file sizes.

Options: High/Standard(default)/Low

### • Filter

Enhance your footage with various filter options.

Options: Normal (default)/Vivid

### • Time stamp

When enabled, the time and date appear as a watermark on your videos and photos.

Options: On/Off(default)

### Gyroscope

The camera's built-in 6-axis gyroscope can detect how you hold the camera, allowing for a more enjoyable capture experience. With Gyroscope enabled, the camera intuitively captures vertical shots when held upright, and switches to widescreen when held sideways.

Options: On/Off(default)

### • Auto shutdown

Specify the auto-shutdown interval for the camera. It will shut down automatically after this time.

Options: Never/1Min/3Min/5Min (default)/10Min

- **Auto screensaver**

Determine when the camera screen turns off automatically. To keep it always on, set this to “Never”.

Options: Never/1Min (default)/3Min/5Min

- **Format microSD card**

Format the SD card. Formatting will delete all files stored in the card, so be sure to back up important files before formatting.

- **Factory reset**

Reset all settings to factory defaults and closes all connections.

- **Camera version**

Check the current version of your camera.

## **(6) OTA Update**

### **Why do you need to perform the OTA update?**

OTA updates are of great importance to enhance your user experience, expand the camera's capabilities, and improve its performance and responsiveness. It is strongly recommended that you perform regular OTA updates via the AKASO GO app, as new upgrade packages for your camera are released frequently.

### **What do you need to do before the OTA update?**

Before initiating an OTA update, ensure:

- ① Your camera's firmware supports OTA updates.
- ② You've installed the latest AKASO GO app on your smartphone.
- ③ A functional Micro SD card is in the camera.
- ④ Functional Micro SD card is in the camera.

## What do you need to pay attention to before the OTA update?

Before initiating an OTA update, please note the following precautions:

- ① Review these guidelines thoroughly.
- ② Always keep the AKASO GO app updated.
- ③ Use a camera-compatible Micro SD card to prevent update glitches. (The card's ability to record guarantees compatibility.)
- ④ Maintain a camera battery charge above 60%.
- ⑤ Set the Auto Power Off and ScreenSaver to "Never", ensuring no disruptions during the update.
- ⑥ Conduct the update in areas with robust network coverage to prevent upgrade failures caused by poor network conditions.
- ⑦ Stay connected to the app and the internet throughout the update process.
- ⑧ Avoid operating the camera during the upgrade, including actions like inserting or removing the SD card, powering the camera on or off, and any other interactions that might disrupt the update.

## How to perform the OTA update?

- ① Download the latest firmware. (**Hint:** If your phone has 4G or 5G network enabled, you can skip Steps 3 and 4 since the firmware will automatically download without requiring a network switch.)

Step 1: In the app's System Settings, tap "Firmware update" to access the download screen.	Step 2: Verify the firmware update version, then tap "Download".	Step 3: Upon receiving a "Connected to the Internet" prompt, select "Switch Networks". This will prompt network settings.	Step 4: Switch to an available network and tap "Completed".	Step 5: The app will automatically download the OTA upgrade package. Ensure a stable network connection until the download is complete.
--	--	---	---	---

② Upgrade the firmware. (After the update, activate your camera and verify its version: **Preferences** → **General Settings** → **About**.)

<p>Step 6: After successfully downloading the OTA upgrade package, tap "Connect to the Camera". A "Connect to the Camera Wifi" prompt will appear.</p>	<p>Step 7: Tap the "Connect" option on the prompt.</p>	<p>Step 8: Once connected to the camera's Wifi, the app will display "Please Wait", indicating the upgrade is in progress. The camera's blue indicator light will flash after remaining steady.</p> <p><b>Note:</b> This usually takes about one minute. Please be patient.</p>	<p>Step 9: The app will show "Update Completed" when the upgrade is done. The camera will be powered off with the blue indicator light turning off.</p>
--	--	---	---

## 12. Remote

Once your camera is paired with the remote, a simple button press lets you take control remotely.

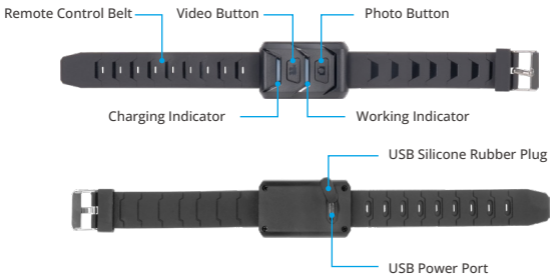

**Note:** The remote is splashproof only.

### 12.1 Connect to the Remote

Follow these steps to connect your Brave 8 Lite action camera to the remote.

- (1) Enable the Remote feature on the camera. To do this, swipe down to access the quick menu, find and turn on the "Remote" option, then return to the main preview screen.

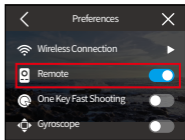
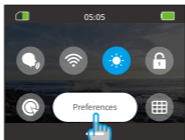

(2) Once paired, you can use the remote to effortlessly control your camera.

※ Ensure the remote is sufficiently charged when using it to control your camera.

## 12.2 Button Operation Instructions

### Video Button

When the camera is in Video mode, press this button to begin or end recording.

### Photo Button

When the camera is in Photo mode, you can use this button to snap a picture.

### Indicators

**Red Indicator:** Remains on while charging and goes off when the remote is fully charged.

**Blue Indicator:** Blinks slowly during video recording; blinks once when capturing photos.



## 13. Mount Your Brave 8 Lite Action Camera

Enhance your user experience by mounting the camera to various gear like helmets and handlebars. Here's a quick guide. Always ensure the camera is securely placed in the protective camera frame.



Then, secure the action camera on the buckle mount.



You can install the camera on a helmet using different accessories.





You can also install the camera on a handlebar.



## 14. Troubleshooting

For in-depth troubleshooting guidance, please refer to AKASO's official technical support page:

<https://support.akasotech.com/hc/en-us>



## 15. Battery Maintenance

### 15.1 Maximizing Battery Life

- (1) Before using the Brave 8 Lite action camera for the first time, charge the battery fully and secure it in its slot.
- (2) Use the Screensaver setting or lower the screen brightness.
- (3) Charge the battery fully before storage.
- (4) To ensure optimal performance, replace the battery annually.

### 15.2 Note

- (1) To prevent potential damage, use only AKASO charging cables and batteries.
- (2) Recording at high resolutions or higher frame rates, especially in warmer conditions, may lead to increased power consumption and the camera heating up.
- (3) The AKASO GO app might generate extra heat and drain power faster in areas with unstable network connectivity.
- (4) If the camera overheats, let it cool down before using it again. Additionally, record videos at lower resolutions and frame rates.

### 15.3 Battery Handling and Storage

- (1) If storing for extended periods, maintain a battery charge of 50-60%. Charge every 3 months and discharge the battery every 6 months.
- (2) Do not store the battery with metal objects such as coins, keys, or necklaces. If the battery terminals come close to metal objects, a short circuit may cause fire.
- (3) Store in dry areas, safe from potential physical damage caused by squeezing or collision.
- (4) Avoid using or storing the battery at high temperatures, such as in direct sunlight or a hot compartment. The battery will heat up, malfunction, or have



its service life shortened in these conditions.

- (5) Avoid using or storing the battery in low-temperature environments, as this will shorten the battery life or cause it to malfunction.
- (6) Avoid environments with strong static or magnetic fields; these can compromise the battery's protective unit, posing safety risks.
- (7) If the battery emits an odor, overheats, changes color, gets distorted, or exhibits any anomalies, discontinue use and remove it immediately from the camera or the battery charger whether it is being used, charged, or stored.
- (8) Safely insulate used electrodes to prevent potential hazards.
- (9) Never discard batteries in fire to prevent the risk of explosion.

## 16. Precautions

- (1) We do not guarantee any reason to give returns within 7 days from the date of purchase.
- (2) Products damaged by misuse are not eligible for returns.
- (3) The product must be returned brand new, together with all its accessories, including paperwork, in its complete original packaging. Please do not dismantle the product for checking, or destroy the packaging.
- (4) Incomplete, lost, or damaged original packaging may render the product ineligible for returns.
- (5) Using the camera while bathing or in hot springs may result in water damage.



## 17. Contact Us

 (888) 466-9222 (US)     [cs@akasotech.com](mailto:cs@akasotech.com)     [www.akasotech.com](http://www.akasotech.com)

For any inquiries about AKASO products, please feel free to contact us.  
We will respond within 24 hours.

